

# KRAMER



## Galil 2-C

### 2.5" Full Range Closed-Back Ceiling Speaker

**Galil 2-C** full range closed-back 2.5" speakers are designed and certified for use in fire alarm systems found in public spaces and all large-scale buildings and offices. Galil 2-C speakers feature flame retardant ABS enclosures, resulting in very light-weight yet robust speakers. Installation is simple, safe, and very fast using the two built-in spring arms.



## EN 54-24 Certified

### Loudspeaker for voice alarm systems

- Multi-purpose speaker with remarkable sound reproduction
- Suitable for all large scale public buildings including universities, schools, hotels, Government structures, and offices
- Quick and easy installation
- Compact, light and low-profile design
- EN 54-24 certified for emergency voice evacuation and alarm systems
- Multi-tap power selection – direct 8Ω or 70V/100V for array installations
- Cost effective
- Built-in robust enclosure offers protection from dust and dripping water

### **GALIL 2-C ADVANTAGES:**

- 10W RMS of added power almost doubles most loudspeakers' output
- Supreme clarity and lucidity for both sound and music
- Versatile and flexible multi-tap power for array installation – direct 8Ω or 70V/100V
- Heat resistant ceramic terminal block for high temperature electric wiring

#### **Galil 2-C**

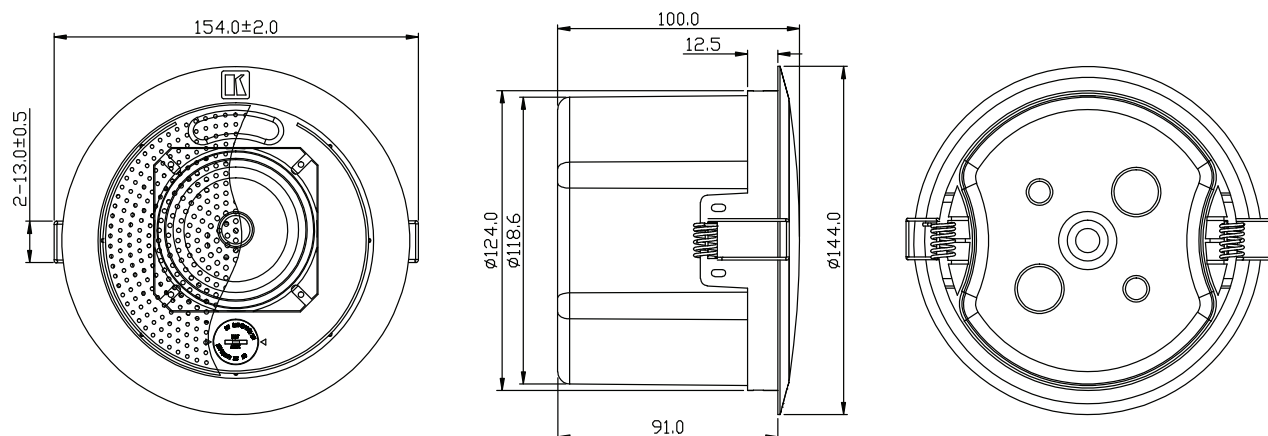



## Galil 2-C SPL vs Frequency and Polar Graphs

### SPL VS Freq Graph

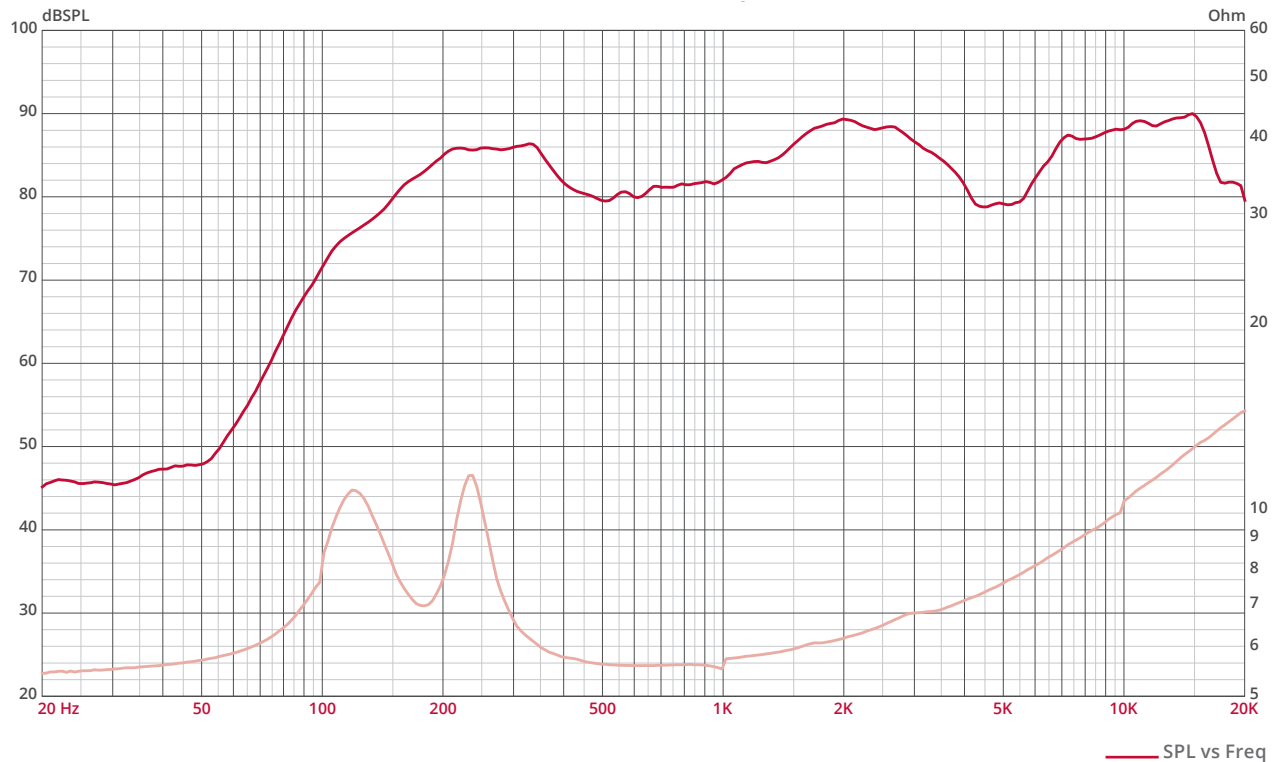

### Polar Graphs

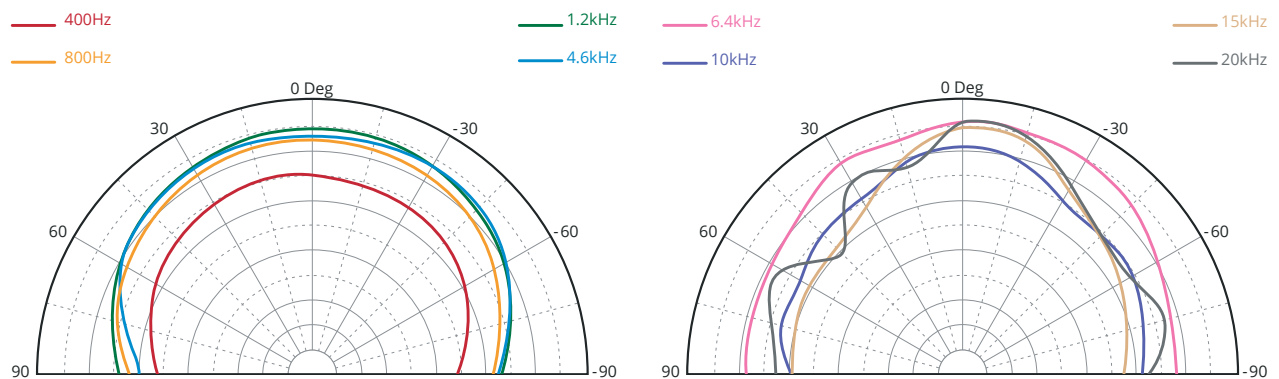

## SPECIFICATIONS

Audio and Power	
DESCRIPTION	Full range closed-back ceiling speaker
FREQUENCY RESPONSE	90Hz to 20KHz @ -15dB 150Hz to 20KHz @ -3dB
WOOFER	2.5" (68mm) Paper cone with rubber surround
IMPEDANCE	8Ω
TRANSFORMER TAPS	70V – 3W, 1.5W, 0.75W, 8Ω/10W (BY-PASS), Off (Lo-Z) 100V – 6W, 3W, 1.5W, 8Ω/10W (BY-PASS), Off (Lo-Z)
SENSITIVITY	83dB SPL, 1W@1m
MAX SPL	Continuous: 93dB Peak: 94.8dB
POWER HANDLING	10W RMS 30W Continuous program
DIRECTIVITY FACTOR (Q)	3.7, averaged 1kHz to 10kHz
DIRECTIVITY INDEX (DI)	5.7dB averaged 1kHz to 10kHz
INPUT CONNECTOR	Ceramic terminal
Shipping and Installation	
MATERIALS	Frame, aluminum grille, safety cord attached to grille, plastic back-can (self-extinguishing ABS)
OPERATING TEMPERATURE	-15° to +70°C (5° to 158°F)
STORAGE TEMPERATURE	-30° to +55°C (-22° to 131°F)
HUMIDITY	25% to 90%, RHL non-condensing
WEIGHT PER SINGLE SPEAKER	0.50kg (1.1lbs) approx.
DIMENSIONS	External diameter: 14.4cm (5.67"); cutout diameter: 12.4cm (4.88")
INSTALLATION CLEARANCE	Mounting depth: 9.5cm (3.74")
OPTIONAL CABLES	BCP-2S, BC-2S, BC-2S12, BC-2S14 speaker cables
COLORS	Available in white
Specifications are within a 10% tolerance and subject to change without notice at <a href="http://www.kramerAV.com">www.kramerAV.com</a>	

### Equalizer requirements for EN54-24 compliance:

Band 2  
Frequency: 2 kHz  
Q: 10  
Gain : -6dB  
Band 3  
Frequency: 5kHz  
Q: 10  
Gain: +6dB

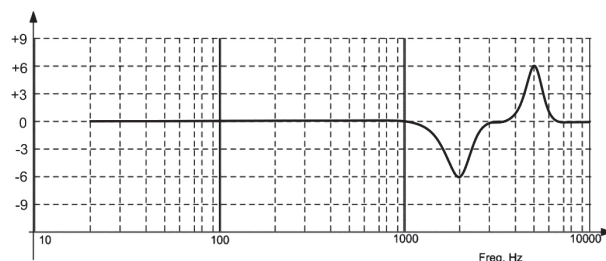

For more information, visit us at: [www.KramerAV.com](http://www.KramerAV.com)

© 2016 KRAMER ELECTRONICS, Ltd. All rights reserved. Reproduction in whole or in part without written permission is prohibited.



Kramer Electronics Ltd.  
3 Am Veolamo St. Jerusalem, 9546303, ISRAEL

#### EN 54-24

Certified loudspeaker for voice alarm systems  
Suitable for fire alarm and emergency voice  
evacuation systems for buildings  
10W two-way ceiling speaker  
Type A