

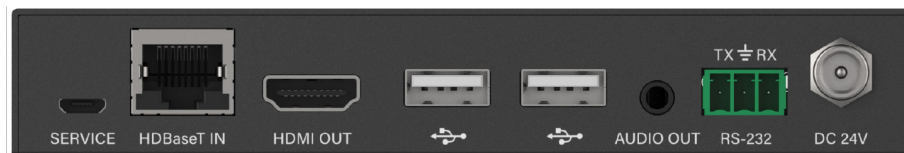

**DIGITALINX**  
VALUE-ENGINEERED DIGITAL SOLUTIONS

## DL-1H1A1U1C-WPKT-W Install Guide

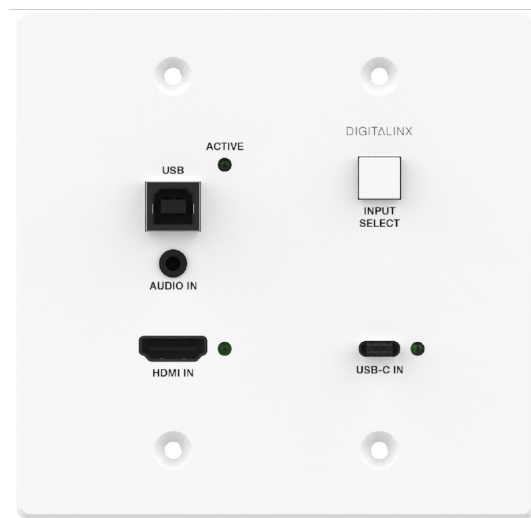

## Product Overview

The Digitalinx DL-1H1A1UC-WPKT-W HDBaseT 2.0 extender set transmits HDMI or USB-C audio and video, analog audio, USB 2.0 High Speed data signals (up to 190Mbps) and RS232 over single category 6 twisted pair cable. The DL-1H1A1UC-WPKT-W can transmit 4K resolutions up to 4K@60Hz, 4:2:0 up to 40m / 120' and 1080P up to 70m / 230'. The 3.5 audio input/output on the system is completely separate and is not dependent on the HDMI or USB input source to be active, this way stereo audio can be transmitted through the system independently. The Digitalinx DL-1H1A1UC-WPKT-W is HDMI 1.4b and HDCP 2.2 compliant. The USB-C input supports ALT-DP mode and can support video, audio, data and power charging up to 40 watts. The DL-1H1A1UC-WPKT-W supports auto switching however an input select button is provided to switch between the HDMI and USB-C inputs manually.

The DL-1H1A1UC-WPKT-W HDBaseT receiver powers wall plate transmitter via HDBaseT so there is no need for an external power supply for the wall plate. However if using the USB-C input for a source device and power charging is required, both the receiver and the wall plate must be powered simultaneously.

The DL-1H1A1U-WPKT-W is sold only as a set. The individual transmitter and receiver are not compatible with other HDBaseT devices due to proprietary PoE circuitry.

## Package Contents

- DL-1H1A1UC-WPKT-W Wall plate extender set
- Quick Install Guide
- (2) 3 Pin phoenix connector
- (1) 2 Pin phoenix connector
- (1) DC24V 2A power supply
- (1) DC24V 1A power supply with US, UK, EU and AU power adapter plugs
- (2) Mounting ears with mounting screws

# Transmitter / Receiver View

## Transmitter

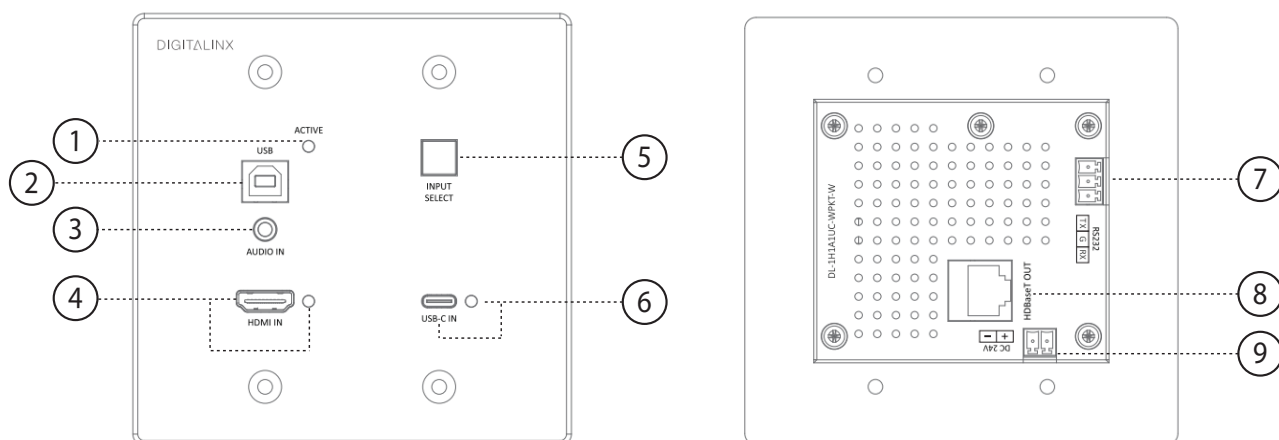

1. ACTIVE LED
  - When LED is solid green, the transmitter unit is active
2. USB - USB B host port
  - USB B host port is active when *HDMI IN* has been selected as the video input
3. AUDIO IN - 3.5 mm analog audio source input
4. HDMI IN - Video source input and LED
  - When LED is green, unit is receiving active HDMI signal
  - When LED is off, no active HDMI signal is present
5. INPUT SELECT
  - Press to toggle between *HDMI IN* and *USB-C IN* inputs
6. USB-C IN - USB Type C Input for video, data, power charging up to 40w and corresponding LED
  - When LED is green, unit is receiving active video signal
  - When LED is off, no active video signal is present
7. RS232 - Serial port for transmitting / receiving RS232 signals
8. HDBaseT OUT - HDBaseT output port
9. DC24V- Phoenix connector for connecting external 2A power supply

**Note:** The DL-1H1A1UC-WPKT-W-TX can receive power via HDBaseT from the receiver when connected together with a Category 6 F/UTP cable. If using the USB-C input for a source device and power charging to the connected source is required, the 2A wall plate power supply must be used to provide 40 watts of power to source.

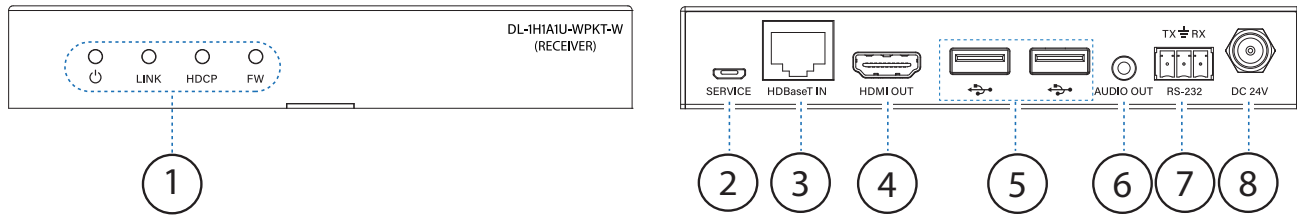
**Receiver****1. ACTIVITY LED'S**

- When *POWER LED* is *ON*, unit is receiving power
- When *LINK LED* is *ON*, the *TX* and *RX* is connected properly
- When *HDCP LED* is *ON*, unit is receiving *HDCP* encrypted content
- When *FW LED* is *ON*, unit is receiving power

**2. SERVICE- For firmware updates****3. HDBaseT IN - HDBaseT input port****4. HDMI OUT - HDMI output to connect to display technology****5. USB- USB A Client side ports**

- Client side hub, can be used for *USB B / HDMI IN* or *USB-C* when selected

**6. AUDIO OUT - 3.5mm analog audio output port**

- Audio output is dedicated to the audio input on the wall plate, does not de-embed HDMI audio

**7. RS232- Serial port for transmitting / receiving RS232 signals****8. DC24V - Locking connector for connecting external 1A power supply**

## Connectivity Instructions

1. Verify all components included with the extender set are present before installation.
2. If the extenders are going to be permanently mounted to a surface, attach the included mounting brackets with the supplied screws.
3. Turn off power and disconnect the audio/video equipment by following the manufacturer's instructions.
4. Connect Category 6 or greater twisted pair cable with RJ45 connectors between the transmitter (DL-1H1A1UC-WPKT-W-TX) and the receiver (DL-H1A1UC-WPKT-W-RX). TIA/EIA-568B straight-through wiring connections must be used with all HDBaseT extenders.
5. Connect an HDMI cable no longer than 5 meters / 15' and any desired control accessories between the display and the receiver (DL-H1A1UC-WPKT-W-RX).
6. Connect a USB-C cable no longer than 2 meters / 6' and any desired control accessories between the source and the transmitter (DL-1H1A1UC-WPKT-W-TX).
7. Connect an HDMI cable no longer than 5 meters / 15' and any desired control accessories between the source and the transmitter (DL-1H1A1UC-WPKT-W-TX).
8. Connect a computer USB port to the transmitter (DL-1H1A1UC-WPKT-W-TX) USB host port.
9. Connect USB peripherals such as white-boards and USB cameras to the USB client ports of the receiver (DL-1H1A1UC-WPKT-W-RX) USB ports.
10. Connect the included 1A power supply to the DL-1H1A1UC-WPKT-W receiver and lock the power supply to the power connector by twisting the locking collar clockwise.
11. *OPTIONAL*- If using the USB-C power charging option, connect the included 2A power supply to the DL-1H1A1UC-WPKT-W wall plate
12. Power on attached audio/video devices. Use the INPUT SELECT button to choose which AV input to switch to

# Cabling Requirements

## HDBaseT Cabling

To ensure proper performance of the DL-1H1A1UC-WPKT-W, it is recommended that you use solid core, shielded Category 6 F/UTP cabling at a minimum. Category 5e F/UTP may perform well but may not support power over HDBaseT reliably.



When using shielded category cabling *ALWAYS*...

....use shielded connectors

....properly ground the category cable

For optimized HDBaseT performance use the following Liberty Wire and Cable branded cabling;

Category 6 plenum; **24-4P-P-L6SH**

Category 6A plenum; **24-4P-P-L6ASH**

Category 6 NON-plenum; **24-4P-L6SH**

Category 6A NON-plenum; **24-4P-L6ASH**

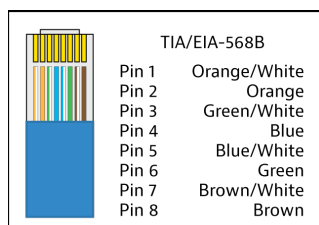

### Twisted Pair Wiring

Use TIA/EIA-568B wiring for Category 6 connection between send and receive units.

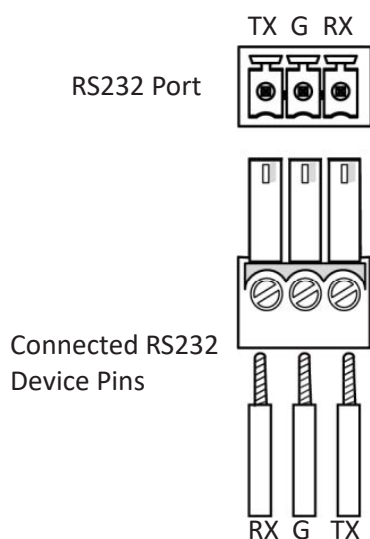

### RS232 Wiring

Connect the controller or device RX signal to TX on the DL-1H1A1UC-WPKT-W extender. Connect the controller or device TX signal to Rx on the DL-1H1A1UC-WPKT-W extender.

## Technical Specifications

<b>VIDEO</b>	
Video Inputs (TX)	(1) HDMI, (1) USB-C
Video Input Connector (TX)	(1) HDMI type A, (1) USB Type C
Input Video Signal	HDMI for HDMI input, ALT-DP Mode for USB-C
Video Output (TX)	(1) HDBaseT
Video Output Connector (TX)	(1) RJ45
Video Output (RX)	(1) HDMI
Video Output Connector (RX)	(1) HDMI type A
Output Video Signal	HDMI
Input Resolutions Supported	Up to 3840 x 2160 @ 60Hz, 4:2:0, 8bit color depth
Standards	Compliant with HDMI 1.4b & HDCP2.2
<b>USB</b>	
Supported USB Standard	USB 2.0 High Speed
USB Data Transfer Bandwidth	190Mbps
USB Port Type	(1) USB Type B, (1) USB Type C (TX) (2) USB Type A (RX)
<b>AUDIO</b>	
Supported output formats (HDMI)	LPCM, Dolby Digital/Plus/EX, Dolby True HD, DTS, DTS-EX, DTS-96/24, DTS High Res, DTS-HD Master Audio, DSD
Supported output formats (Analog)	PCM 2.0
Audio Input / Output	Stereo analog
Audio Input / Output Connector	(1) 3.5mm TRS audio jack
Audio Output Impedance	70 Ohms
Frequency Response	20Hz~20K Hz
<b>CONTROL</b>	
Control Port / Connector	(1) RS232 (TX) / 3 phoenix connector (1) RS232 (RX) / 3 phoenix connector
<b>OTHER</b>	
System Bandwidth	10.2Gbps
Operating Temperature	-10C ~ +40C
Storage Temperature	-20C ~ +60C
Humidity	20% ~ 90%
Power Supply	Input:100V~240V AC; Output: 24V DC 2A (TX) Input:100V~240V AC; Output: 24V DC 1A (RX)
Power Consumption	10 watts
Dimension (W*H*D)	TX:116mm * 114mm * 39mm / 4.6" * 4.5" * 1.5" RX:140mm * 23mm * 75mm / 5.5" * .9" * 2.9"
Weight	TX:300g / .7 lbs RX:200g / .44 lbs
Warranty	5 years
Certification	CE, FCC, RoHS

Thank you for your purchase.

For Technical Support please call our toll free  
number at 800-530-8998 or email us at supportli-  
bav@libav.com

[www.libav.com](http://www.libav.com)

Digitalinx is a brand of:



11675 Ridgeline Drive  
Colorado Springs, Colorado  
80921 USA  
Phone: 719-260-0061  
Fax: 719-260-0075  
Toll-Free: 800-530-8998