

Overview

Flat cables provide several benefits including weight reduction, space efficiency, flexibility and strength. The following Flat Cables are available to purchase from AMX:

CBL-HDMI-FL-16: HDMI Flat Cable

CBL-HDMI-FL-16 Cable Specifications	
FG#:	FG10-2180-16
Cable Length	16.4 ft (5m)
Connectors:	<ul style="list-style-type: none"> • SOURCE: HDMI (male) - connects to the source device. • DISPLAY: HDMI (male) - connects to the display device. • Molded Strain Relief
Data Rate:	10.2 Gbps
Signal Support:	1920×1080P @ 120
Refresh:	120 Hz
Color:	48 Bits (16 bits per color)
Supported Features:	Deep Color, 3D, HEC, ARC
Plating:	24K Gold

CBL-DP-FL-16: DisplayPort Flat Cable

CBL-DP-FL-16 Cable Specifications	
FG#:	FG10-2181-16
Cable Length	16.4 ft (5m)
Connectors:	<ul style="list-style-type: none"> • SOURCE: DisplayPort (male) - connects to the source device. • DISPLAY: HDMI (male) - connects to the display device. • Molded Strain Relief
Data Rate:	10.2 Gbps
Signal Support:	1920×1080P @ 120
Refresh:	120 Hz
Color:	48 Bits (16 bits per color)
Supported Features:	Deep Color, 3D
Plating:	24K Gold

Directional Cables

The **CBL-HDMI-FL-16** and **CBL-DP-FL-16** cables are *directional* (FIG. 1): The connector labeled **SOURCE** must be connected to the source device (example: Blu-ray player) and the other connector labeled **DISPLAY** connects to the display device (example: HDTV monitor).

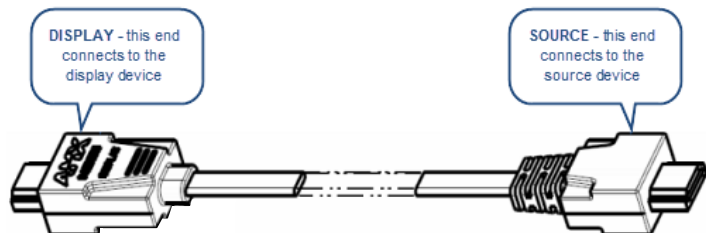

FIG. 1 Directional flat cable

Directional Cables: Notes

- Use of an extension cable on either end of the CBL-HDMI-FL-16 and CBL-DP-FL-16 cables should be avoided, or performance issues may result.
- Connecting the cable backwards, with the connector labeled "DISPLAY" into the video source, will not damage the equipment. However when incorrectly installed, the cable will not transmit a signal.

CBL-RGB+A-FL-16: RGB-Audio Flat Cable

CBL-RGB+A-FL-16 Cable Specifications	
FG#:	FG10-2183-16
Cable Length	16.4 ft (5m)
Connectors:	<ul style="list-style-type: none"> • SOURCE: 15-pin HD VGA (male), with two 3.5mm ports (female): The port labeled with the Speaker icon connects to the source device, via the separate (included) <i>Stereo Audio Patch Cable</i>. The port labeled with the Plug icon is <i>inactive</i> - use this port to store the <i>Stereo Audio Patch Cable</i> when not in use. See FIG. 2 for details. • DISPLAY: 15-pin HD VGA (male), with a 3.5mm Stereo pigtail (male) - connects to the display device. The pigtail is 12" (30.5cm) long. • Molded Strain Relief
Included:	3.5mm Stereo Audio Patch Cable (18" / 45.7cm)

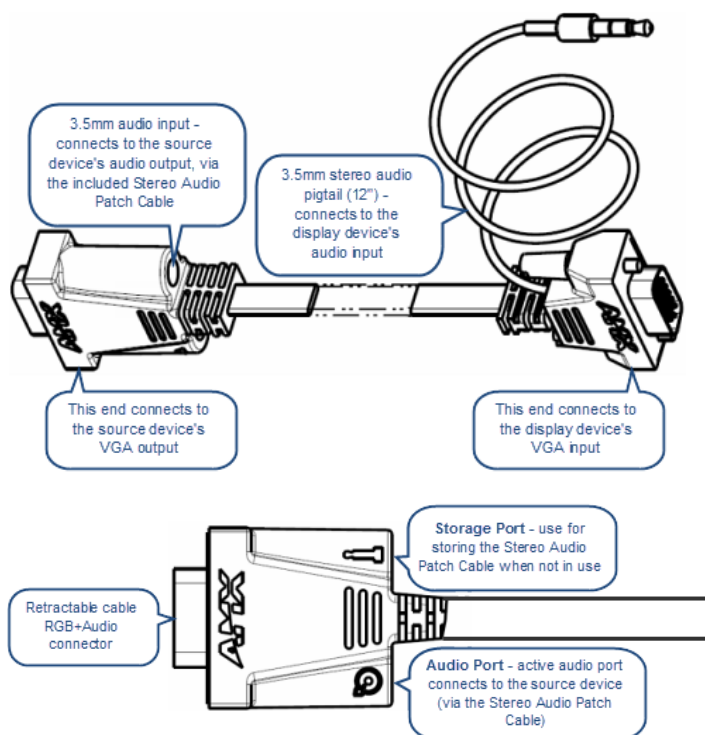

FIG. 2 RGB + Audio flat cable and SOURCE connector details

Use the separate 3.5mm *Stereo Audio Patch Cable* (included) to connect to the audio output on the Source Device.

CBL-ETH-FL-16: Ethernet Flat Cable

CBL-ETH-FL-16 Cable Specifications	
FG#:	FG10-2182-16
Cable Length	16.4 ft (5m)
Connectors:	<ul style="list-style-type: none"> • RJ45 (male, both ends) • Molded Strain Relief
Category:	CAT 5e
Wiring:	<ul style="list-style-type: none"> • 26 AWG • 4 twisted pairs • Single-core

Additional Documentation

Refer to the *Products > Architectural Connectivity* catalog page on www.amx.com (Dealer Site) for additional product documentation.