

AP-15U, AP-15TU, AP-15TUC

Emergency Signaling Loudspeakers

General Description

- Atlas Sound Models AP-15U, AP-15TU and AP-15TUC are high efficiency, U.L. Listed double re-entrant type loudspeakers. They comply with the requirements of UL Standard 1480, Fire Protective Signalling Speakers.
- They are designed to be used in conjunction with compatible control equipment for high intelligibility reproduction of audible emergency and protective signals as well as voice messages.
- Model AP-15TUC includes a supervisory capacitor and is suitable for installation in systems employing supervised circuitry (25V/70.7V). Maximum supervised circuit voltage is 24VDC.
- For use in ambient temperature ranges from -40°C to 66°C.

Specifications

POWER: 15 Watts RMS

FREQUENCY RESPONSE: 400Hz-4kHz

CONDUIT CONNECTION: For 1/2" Conduit

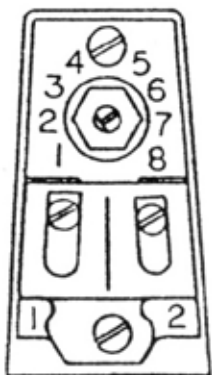

Power Tap Selector Switch

Switch Position	Impedance	25V Line	SPL"@ 10 Ft.	70.7V Line	SPL"@ 10 Ft.
1	5.0 KΩ	-		.9 Watts	93dB
2	2.5 KΩ	-		1.8 Watts	96dB
3	1.3 KΩ	.48 Watts	90dB	3.8 Watts	98dB
4	666Ω	.94 Watts	93dB	7.5 Watts	101dB
5	333Ω	1.8 Watts	96dB	15.0 Watts	103dB
6	89Ω	7.5 Watts	101dB	Do Not Use	
7	45Ω	15.0 Watts	103dB	On 70 V.	

* UL 3dB Increment Rating

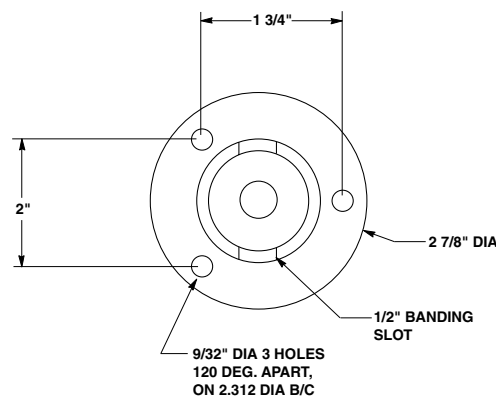

NOTE: Terminal #1 is the negative terminal
Terminal #2 is the positive terminal

Mounting Dimensions

Wiring Diagram

To conform with UL requirements, wires must be connected as shown in wiring diagram.

NOTE: The maximum wire size that can be connected to this device is 18-Gauge.

From
Amplifier

Speaker 1

Speaker 2

To next Speaker
or End of Line
Resistor

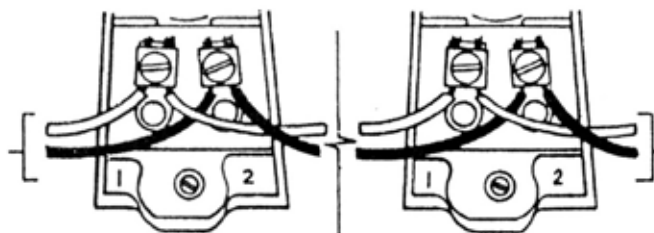

CAUTION: Do Not loop wires under screw terminals. Break wire run to provide supervision of connection. Installation must comply with all building codes and NFPA guidelines. Installation must adhere to N.E.C. and NFPA 70/72 wiring directives and comply with all national and local building codes.