

Arrive HuddlePoint™ 4010-CMMH

BYOC Cable Media Management Hub

Model AHP-4010-CMMH



Presenting HuddlePoint™, the industry's first flat-top Unified Media Collaboration Appliance (UMCA) series. Our UMCA platform marks the introduction of an advanced, integrated all-in-one (AIO) in-room wired cable management and integrated AV source switching system which includes:

- Wired Multi-Format AV switching and scaling for legacy and wired connected device presentations.
- Video source input auto-switching
- Smart device DC charging function
- Tabletop universal AC socket for laptops and chargers
- Built-in USB 3.0 Hub

These capabilities are packaged in one user-friendly interface. Our single AIO appliance delivers a powerful and efficient in-room collaboration experience for huddle rooms, small meeting rooms, classrooms and hotel guest rooms.

Arrive's HuddlePoint™ product line is the industry's first generation of universally integrated devices - supporting the most commonly used wired video connectivity platforms in a single device. This positions Arrive's HuddlePoint™ as the most innovative and cost effective interface for tabletop applications.

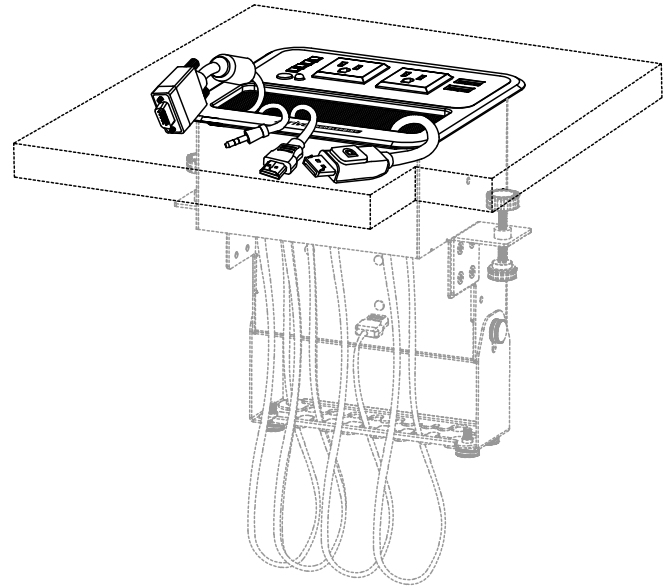

AHP-4010-CMMH



Key Features



Mainstream Wired BYOD: Built-in wired video inputs for DisplayPort, HDMI and legacy VGA+VGA Audio laptops and PCs



Auto-Video Source Switching: Display user selected wired video sources to a single HDMI connected display

- AV signals auto-switch upon connection sensing



Cable Management: Provides cable management receptacle where physical DisplayPort, HDMI, VGA and other pull out cables are housed for user convenience

- Eliminates the need for additional break-out cables to be connected and disconnected each time



USB3.0: Offers faster transfer rate with its ease-of-use and plug and play making a huge difference in the world of usb peripherals including cameras, external microphones, interactive whiteboard and more



Universal Fast Charging of Smartphones and Tablets: Built-in Universal USB DC fast charge ports provide universal charging to mainstream smartphones and tablet devices



Many ways to control: Convenient user control via Auto-Switching of digital inputs, Button Panel Control with LED indicators and RS-232 control from third party control devices



Processing

Wired BYOD

Integrated Display Port, HDMI and VGA + VGA audio input. Physical connection ports with auto-switching on digital inputs. VGA is scaled to HDMI with audio embedded. HD out supports 1080p 60Hz on all source channels - wired. EDID pass through on wired sources.

User Panel A Input / Output Connections

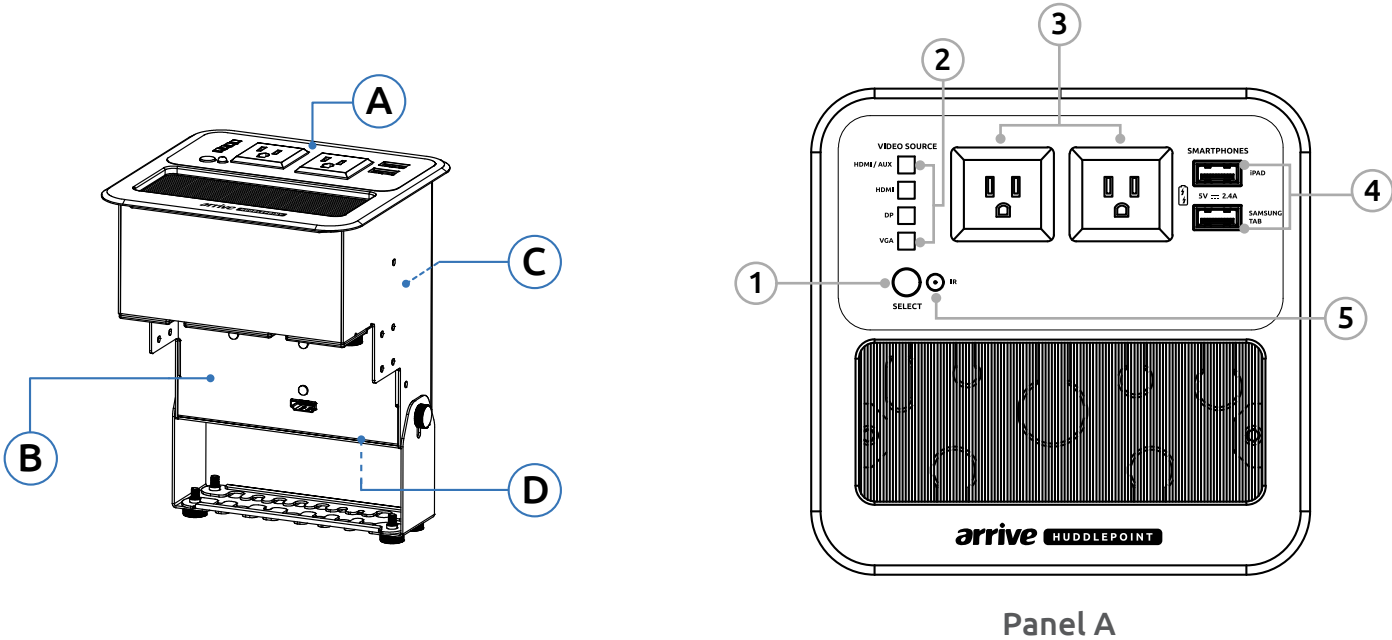

User Top Panel

1	Manual Source Select	Select the input source from a choice of wired VGA, Display Port, HDMI or HDMI / AUX connected devices. Auto cycles to only connected devices, skipping non-connected sources.
2	Video Source, LED indicator	LED indicator highlights the connected video source that is being output to the large screen display.
3	AC Input / Output	AC 110V for connecting laptops and smartphone charging adapters via universal socket.
4	Universal Fast Charge	Dual high-speed ports located on the top panel allow quick charging of USB devices. Simply plug your device(s) into one or both of the supplied ports. Both top panel ports can charge most smartphones such as iPhone, Amazon Fire Phone and some of the Nokia Windows and Samsung Galaxy series phones. Use device approved USB cables only. Supports 5V-DC Max 2.4A Fast Charge <ul style="list-style-type: none">• 1x USB port on the left is optimized for Apple 2A and USB Battery Charger (BC)• 1x USB port on the right is optimized for Samsung Galaxy Tablet 2A and USB Battery Charger (BC)
5	IR Receiver	Use the IR handheld remote control to switch sources. Needs line of sight.

Front Panel B Input Connections

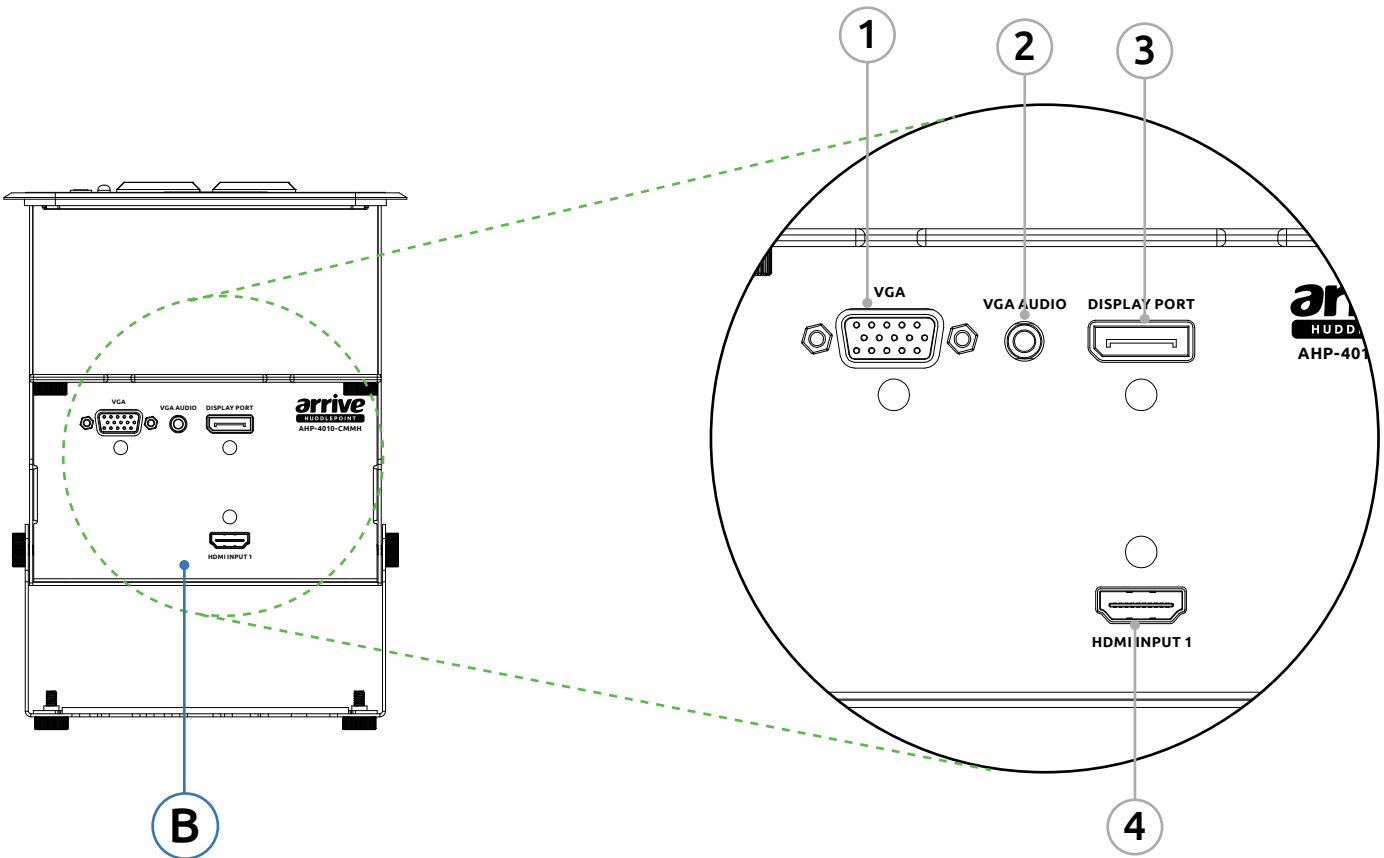

Panel B

Front I/O Panel

1	VGA Video Input	Connect standard 15 Pin HD legacy VGA cable to this port to enable VGA video source to be captured and converted to HDMI signal as a user selected output to display. Pull out cable of extendable length is provided by installer on site. Cable not included.
2	VGA Audio Input	Connect standard stereo audio 3.5mm male jack to this port to enable VGA audio source to be captured and embedded with the VGA video signal. Output is converted to HDMI signal. Cable not included.
3	Display Port Video Input	Connect standard 20 Pin Display Port cable to this port to enable DP video source to be converted to HDMI signal as a user selected output to display. Pull out cable of extendable length is selected and provided by installer on site. Cable not included.
4	HDMI Video Input	Connect standard 19 Pin HDMI cable to this port to enable HDMI video source to be user selected as an output to display. Pull out cable of extendable length is selected and provided by installer on site. Cable not included.

Panel C Recessed Back Input / Output Connections

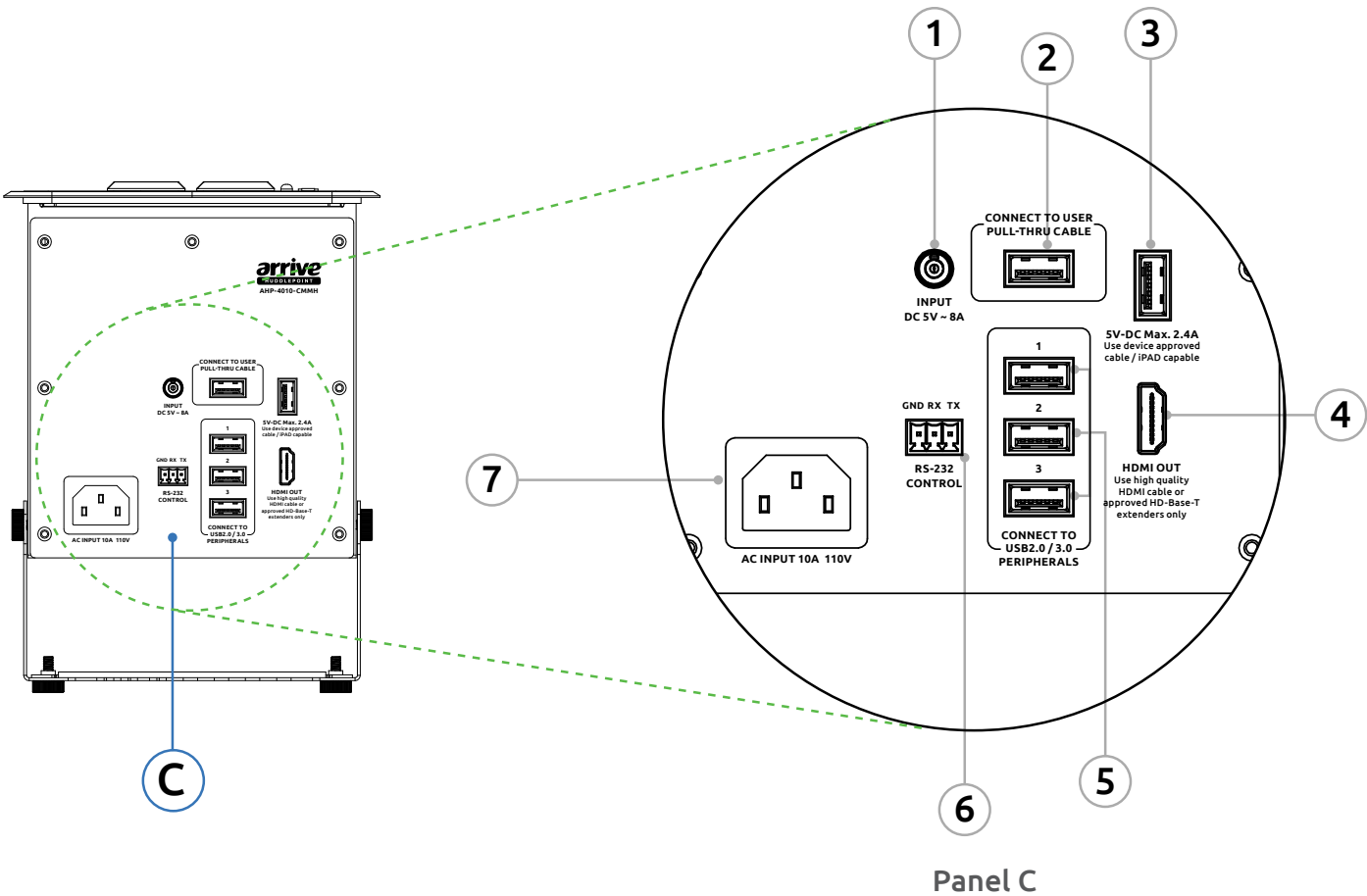

Recessed I/O Panel

1	DC Input	Connect the factory provided 5V - 8Amp DC power adapter to this screw-on terminal.
2	USB3.0 Host	Single USB connection to user PC which allows peripherals such as microphones, cameras and touch displays to be operated from a single wire connection.
3	Universal Fast Charge	Provides external DC power upto 5V 2.4 Amp max. to any third party device. Capable of charging Apple iPad devices, and can charge most smartphones such as iPhone, Amazon Fire Phone and some of the Nokia Windows and Samsung Galaxy series phones. Use device approved USB cables only. Not compatible with Samsung Galaxy tablets.
4	HDMI OUT	Connect a single large screen HD display to this port using a high quality HDMI cable or approved HD-Base-T HDMI extender.
5	USB3.0 Peripherals	Offers faster transfer rate with its ease-of-use and plug and play making a huge difference in the world of usb peripherals including cameras, external microphones, interactive whiteboard and more
6	RS-232 Control	Control the AV switcher using third party control systems through RS-232 commands. Select the desired video source remotely without using the button panel. Refer to user guide for RS-232 command sets.
7	AC Input/Output	AC Input 10A 110V for connecting laptops and smartphone charging adapters via universal socket.

Panel D Bottom Input Connection

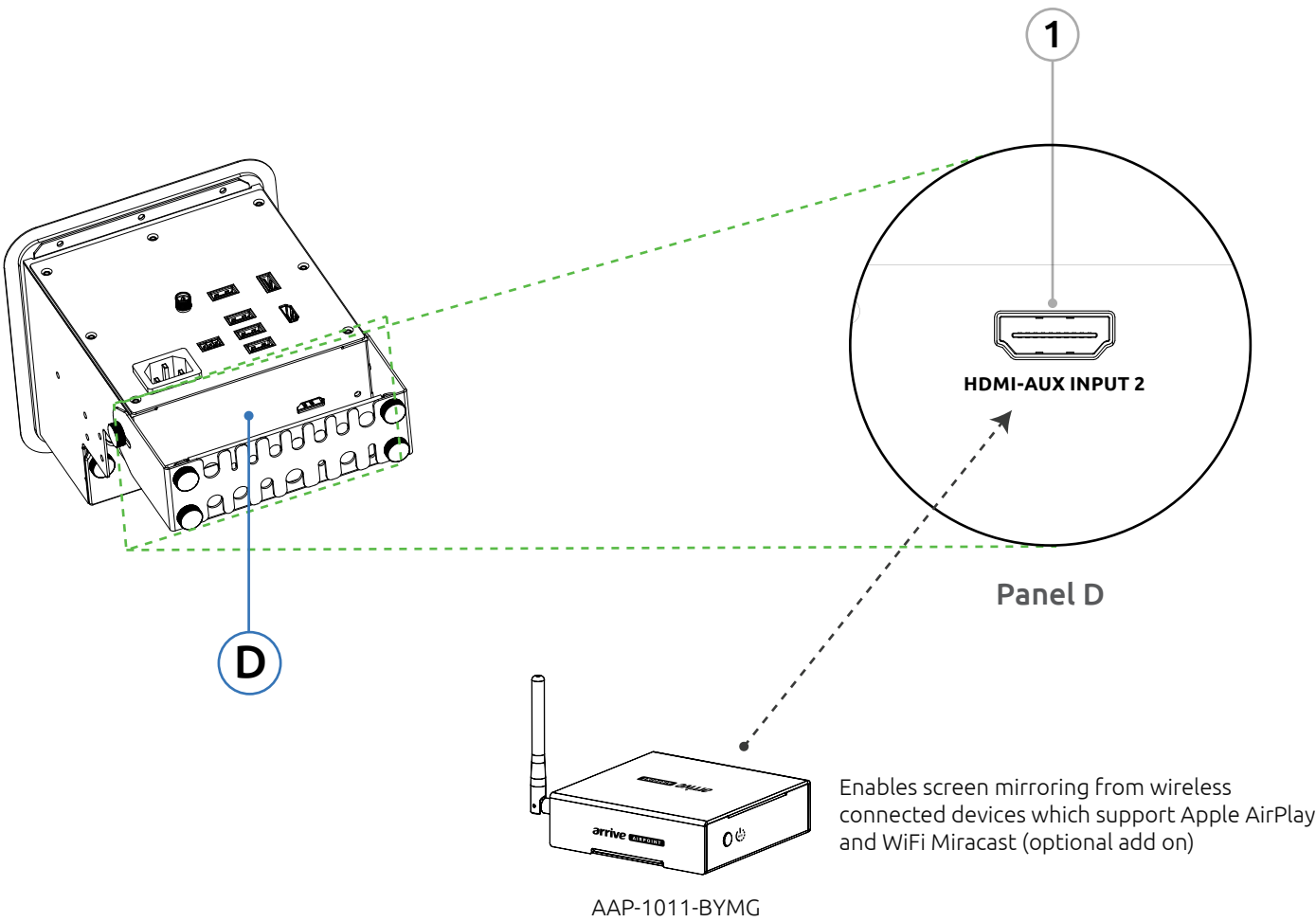

Bottom Panel

1	HDMI AUX IN Port	HDMI auxiliary input for connecting Arrive AirPoint wireless presenter or other third party media devices such as Apple TV, Android TV and wireless presenters
---	------------------	--

Operating requirements

Power requirements	Input DC 5V 8Amp
Power consumption	70 W Max
Operating temperature	5 to 30°C (23 - 86 °F)
Operating Position	Horizontal
Storage temperature	5-35°C (23 - 95 °F)
Operating Humidity	10-55%

SPECIFICATIONS

Arrive HuddlePoint™ 4010 - BYOC Cable Media Management Hub

Model AHP-4010-CMMH

Assembly and Mounting

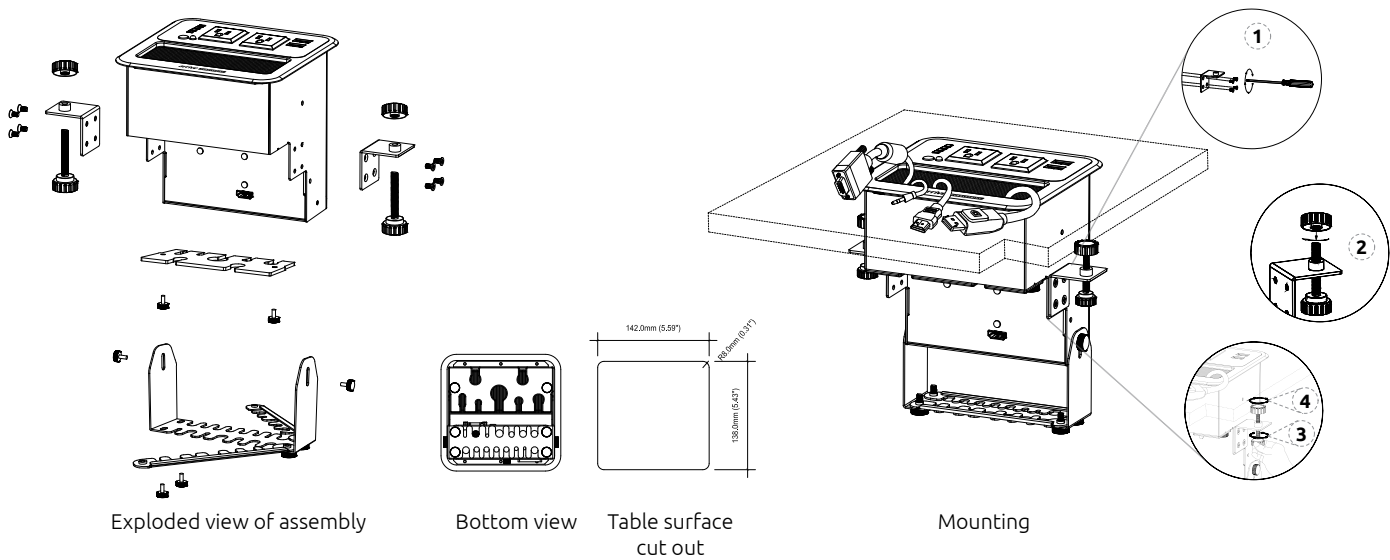

Frame / Case	Recyclable aluminum alloy flat-top plate with metal powder coated body
Color	Black anodized brushed aluminum top plate - black metal powder coating elsewhere
Mounting	Table top
Mounting Kit	Table top mounting kit included with installation instructions

Included hardware:

- 1x 5V - 8Amp power adaptor and cable
- 2x under table mounting brackets with screws
- 1x cable management kit
- Quick installation guide

Installation and System requirements

- Requires physical surface cut-out using installation template for mounting and fixing.
- Requires installer to select wired inputs such as Display Port, HDMI and VGA+VGA Audio and install table. surface sized pull out high quality cables to provide pull out wired video connection facility.
- HDMI enabled display device (i.e. television, projector) and HDMI cable.
- Available AC Input / Output capability.

Certification and compliance

Regulatory certification	FCC-Class A, CE
Environmental compliance	RoHS, WEEE

SPECIFICATIONS

Arrive HuddlePoint™ 4010 - BYOC Cable Media Management Hub

Model AHP-4010-CMMH

Dimensions and Weights*

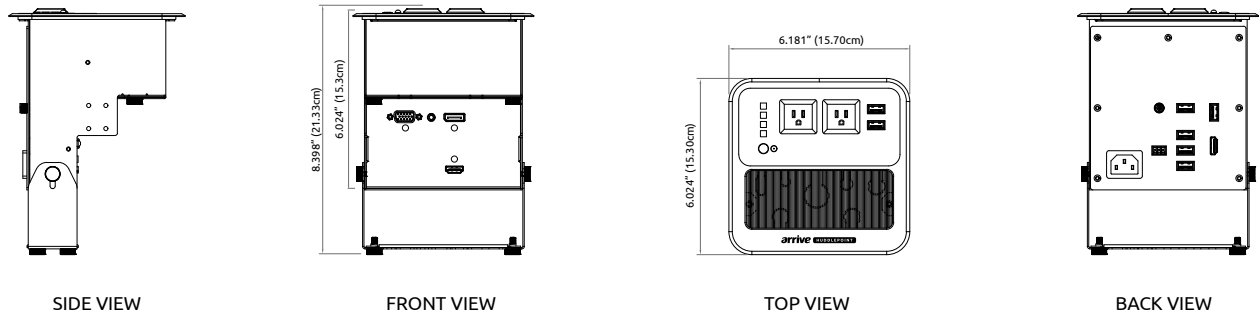

Net Weight/unit	4.29 lbs (1.95 kg)
Unit dimension	6.18" x 6" x 6" (15.7 x 15.3 x 15.3cm)
Gross Shipping weight	4.85 lbs (2.2 kg)

Purchasing information

Model No	AHP-4010-CMMH
Description	Arrive® HuddlePoint™ 4010-CMMH BYOC Cable Media Management Hub with Wired BYOD, universal fast charge for mobile devices, built in USB 3.0 hub, cable management, AC Input/Output capability.
SKU#	AHP-4010-001-001
Warranty Information	All Arrive Peripherals ship with a standard limited 12 months first user warranty. Please refer to Ver. SLHW-P-0101-15 - visit carepoint.arrivesys.com/warranty for updated information on warranty.

-This product is protected by Existing and Patent-pending status.-