

Welcome!

We greatly appreciate your purchase of your TNP130 Podcast Tilt 'N Plug Jr. Interconnect Box. We are sure you will find it reliable and simple to use. Superior performance for the right price, backed by solid technical and customer support is what Altinex offers.

We are committed to providing Signal Management Solutions® to our customers for the most demanding audiovisual installations at competitive pricing and we welcome you to join the ranks of our many satisfied customers throughout the world.

1. Precautions and Safety Warnings

Please read this manual carefully before using your TNP130. Keep this manual handy for future reference. These safety instructions are to ensure the long life of your Tilt 'N Plug Jr. and to prevent fire and shock hazards. Please read them carefully and heed all warnings.

1.1 General

- Qualified Altinex personnel or their authorized representatives must perform all service.

1.2 Installation Precautions

- For best results, place the Tilt 'N Plug Jr. in a dry area away from dust. To prevent fire or shock, do not expose to water or moisture. Do not place in direct sunlight, near heaters or heat-radiating appliances, or near any liquid. Exposure to direct sunlight, smoke, or steam can harm components.
- Handle carefully; dropping or jarring can damage the bezel.
- Never place fingers inside the opening on either side of the unit; injury can occur due to sharp edges inside.

- Do not place heavy objects on top of the TNP Jr. Do not use excessive force to push down on the top of the unit.
- Install all cables according to the instructions herein. Do not force or pull any cable that is attached to the TNP Jr.

1.3 Cleaning

- Surfaces should be cleaned with a dry cloth. Never use strong detergents or solvents such as alcohol or thinner. Do not use a wet cloth or water to clean the unit.

1.4 FCC Notice

- This device complies with Part 15 of the FCC Rules. Operation is subject to the following two conditions: (1) This device may not cause harmful interference, and (2) this device must accept any interference received, including interference that may cause undesired operation.
- This equipment has been tested and found to comply with the limits for a Class A digital device, pursuant to Part 15 of the FCC Rules. These limits are designed to provide reasonable protection against harmful interference when the equipment is operated in a commercial environment. This equipment generates, uses, and can radiate radio frequency energy and, if not installed and used in accordance with the instructions found herein, may cause harmful interference to radio communications. Operation of this equipment in a residential area is likely to cause harmful interference in which case the user will be required to correct the interference at his expense.
- Any changes or modifications to the unit not expressly approved by Altinex, could void the user's authority to operate the equipment.

2. Installation Procedures

Step 1. Cut an opening into the table's surface. Refer to the Altinex website at www.altinex.com for table cutout requirements.

Note: The table can be 2.25" (57mm) or less. Always confirm dimensions before cutting to ensure specifications have not changed.

Step 2. Insert the TNP130 into the table cutout.

Step 3. Place the support brackets under the table and place them between the support mount grooves on the side of the unit. Attach brackets to the groove at the desired height and secure them to the bottom of the table using the knurled table securing screws provided with the additional wing nuts for added tightening. See Diagram 3 for details.

Step 4. To lower the unit, push on the top cover until it locks into place.

Step 5. Secure the cables using the provided cable clamps and screws. Pass the cables from the bottom of the housing and attach it to the table using the cable clamp and screw supplied with the TNP Jr. Leave enough slack in the service loop to allow for easy opening and closing, but not too much as to cause excess drooping of the service loop.

Step 6. Connect the appropriate cables with the correct input connectors on the bottom of the unit. For cough button see attached no terminated wires diagram.

Step 7. Once you connected the proper cables on the bottom of the unit you may raise the unit by pushing down on the front of the top cover. The latching mechanism releases and the unit raises into position. To lower the unit, push on the top of the TNP Jr. until it locks into place.

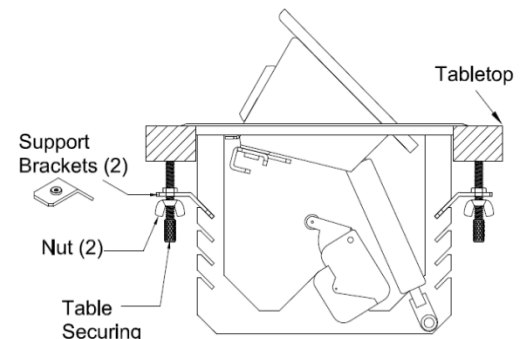

Wiring diagram

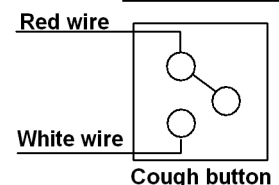

3. Limited Warranty/Return Policies

Please see the Altinex website at www.altinex.com for details on warranty and return policies.

4. Technical Specifications

Specifications are subject to change. See www.altinex.com for up-to-date information.

Features/Description	TNP Jr.
TNP130 *	
Audio, Video, Communication *	6 ft. (2 m)
Digital Video/Audio	HDMI*** Type A F-M (1)
USB	3.0 USB Type A F-M (1)
Stereo Audio	1/4-inch F-M (1)
Cough button	SPST momentary switch (1) 2-conductor cable with unterminated wires
Volume Control	Knob
Accessories Included	
Hardware	-Mounting screws/nuts/brackets -Cable clamps/screws

Table 1. TNP130 General

Mechanical	TNP Jr.
TNP130**	
Max. Table Thickness	2.25 in (57 mm)
Height, opened	5.5 in (140 mm)
Width	4.6 in (117 mm)
Depth	4.9 in (124 mm)
Weight (approx.)	2.8 lb. (1.3 kg)
Shipping Weight	4.5 lb. (2.0 kg)
Finish	Standard: Matte Black Models ending in S: Brushed Aluminum
T° Operating (T° Max)	10°C-35°C (40°C)
Humidity	90% non-condensing

Table 2. TNP130 Mechanical **

* Models ending in S have brushed aluminum finish.

** Dimensions include the "S" models.

*** HDMI, the HDMI Logo, and High-Definition Multimedia Interface are trademarks or registered trademarks of HDMI Licensing LLC in the United State and other countries.

5. The TNP130 Interconnect Box

- Built-in cough button
- Built-in headset volume control
- 1/4-inch headset plug
- USB (CM11370) and HDMI (CM11346)
- Tilt-up design for easy access
- Completely hidden when closed
- Black color
- Downloadable cutout available



The TNP130 is a podcast unit designed with headphone jack, cough button, volume control knob, HDMI input, and USB connections. The TNP130 podcast Tilt 'N Plug Jr. is a simple to use tabletop interface that simplifies a podcaster's job.

Features include a 1/4-inch headphone jack, a cough button (momentary switch), and a volume control knob. There is an HDMI (CM11346) input to route laptop or other video to a presentation display. Also, a USB (CM11370) connector provides additional functionality as an input to a room computer or can be connected to a USB power supply to charge phones, tablets, or other devices.

The TNP130 comes in black, but other colors can be supplied based on customer's request. The podcast Tilt 'N Plug Jr. has 6 ft. cables attached for each of the connections. The cough button provides a shielded cable with two unterminated wires at the end of the 6 ft. cable. The two wires can easily be wired into any sound system. The cough button is a simple normally-open momentary switch.

The TNP130 can be customized with custom labeling including images and logos, colors, and connectors to meet your needs.

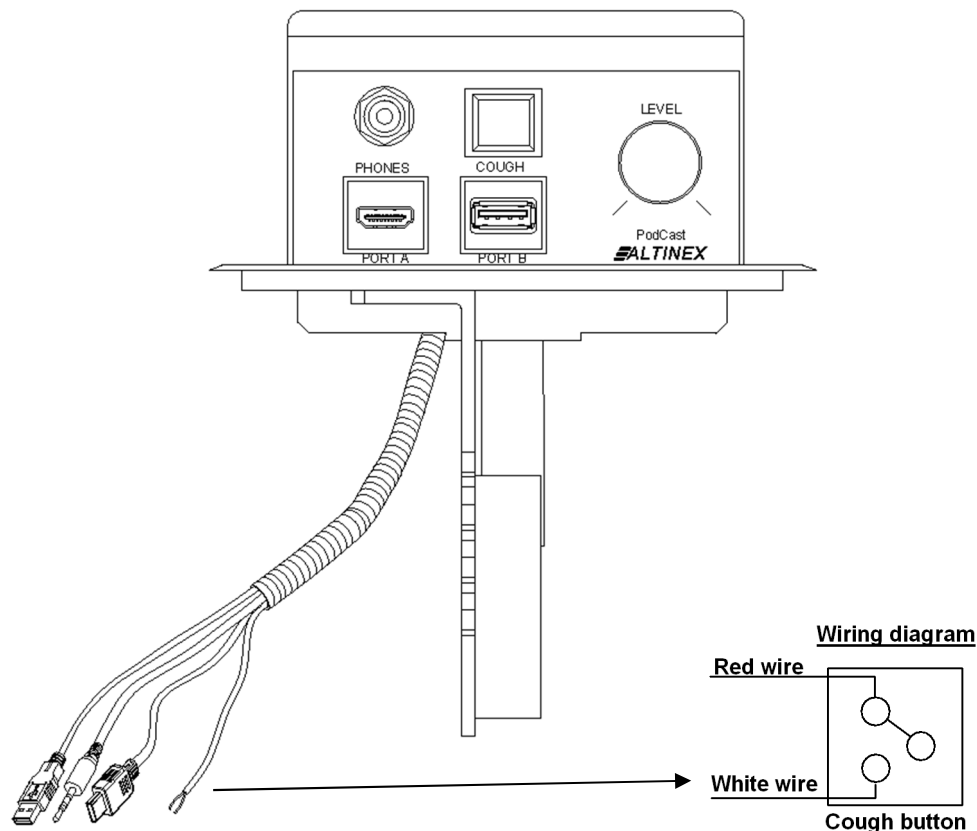

6. Application Diagrams

Diagram 1: Typical Setup and use of a TNP130

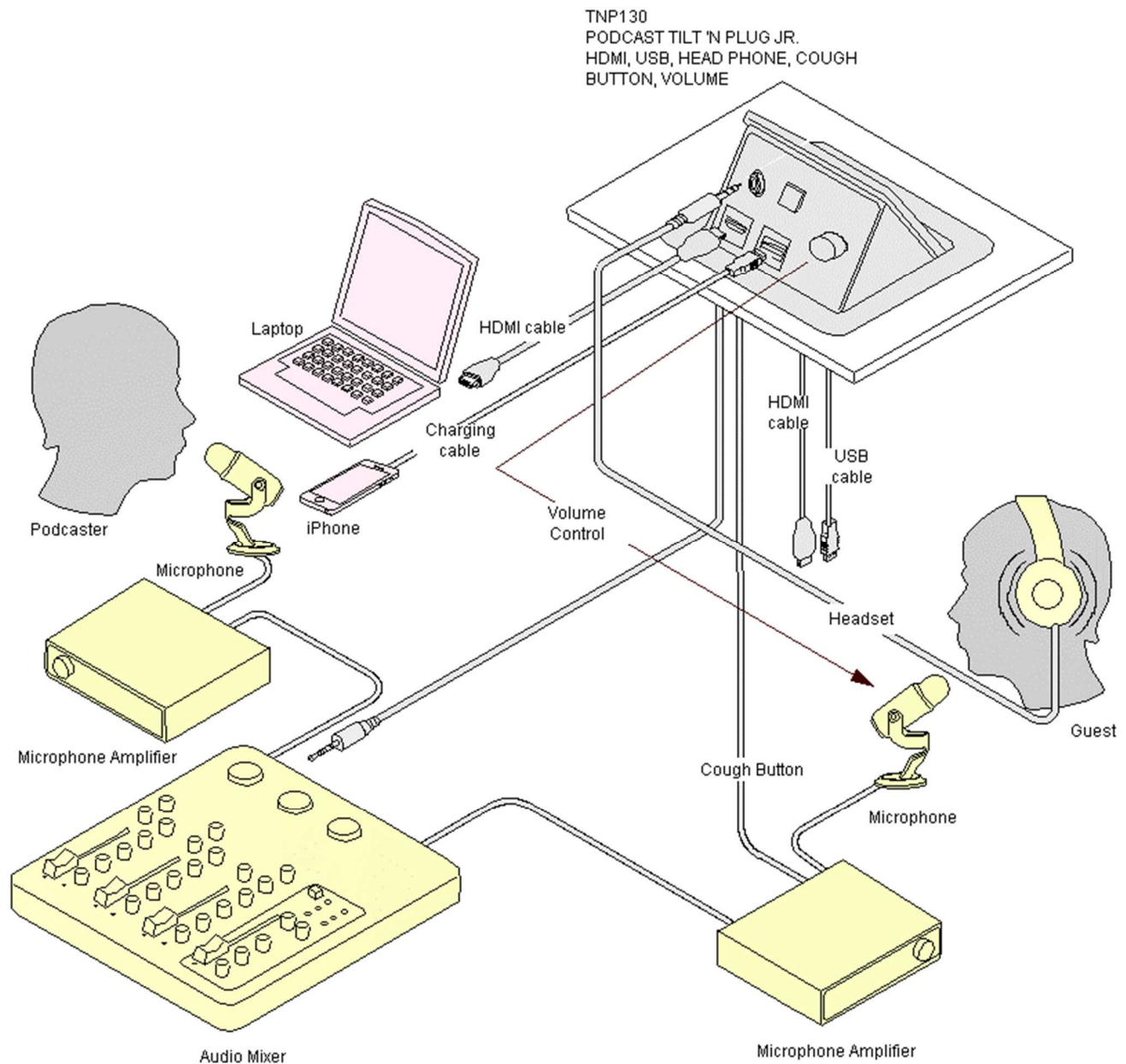

Diagram 2: Dimensions

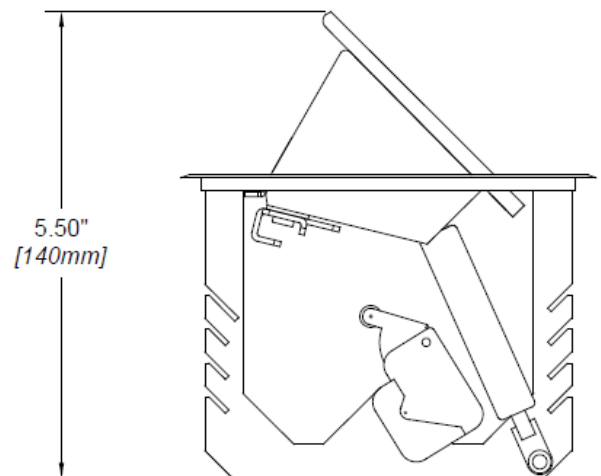
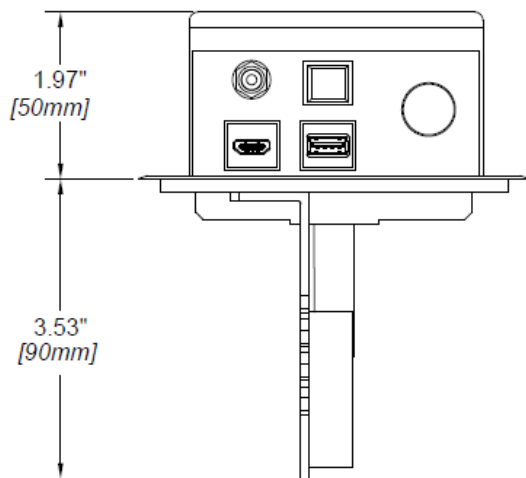
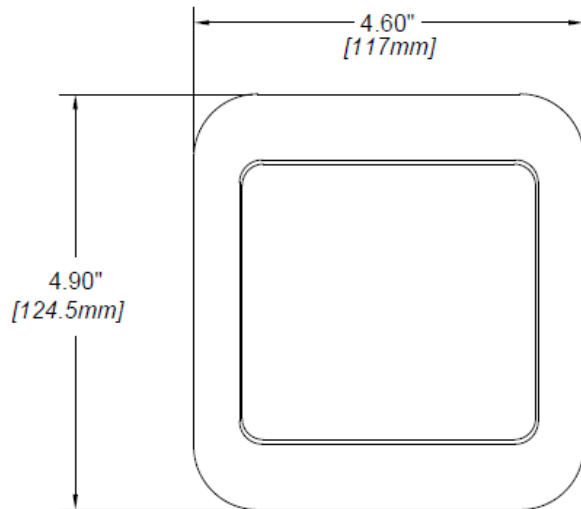
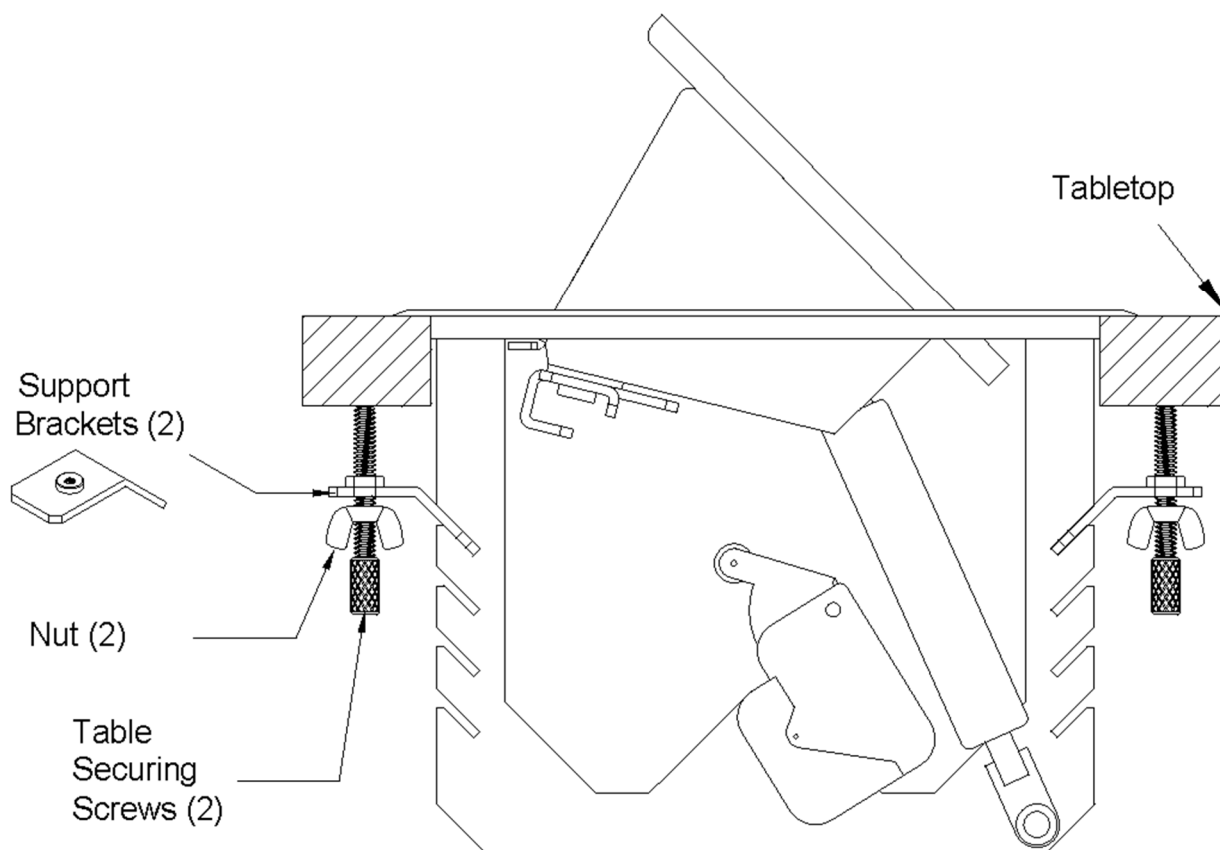

Diagram 3: Mounting



7. Operation

7.1 Opening and Closing the Tilt 'N Plug

The Tilt 'N Plug will open easily when the top is pressed down and then released.

When the Tilt 'N Plug is not in use, simply press the top down until it is level with the surface of the table and then release. The unit will remain hidden until needed again.

7.2 Signal Connections

Connect external devices to the appropriate connector on the Tilt 'N Plug.

8. Troubleshooting Guide

The Tilt 'N Plug supplied was carefully tested and no problems were detected. However, we would like to offer the following suggestions:

TNP	
Symptom	Resolution
Signal quality is poor.	<ol style="list-style-type: none"> 1. Please make sure that the highest quality video and network cables are used. 2. The TNP is a passive unit and does not alter signals in any way. If there is suspected problem with the signal quality, check the quality of the cables coming into the TNP and connecting to the output of the TNP. If they are too long, of low quality, or improperly assembled, this will affect the overall quality of the signal.
Unit raises too slowly	<ol style="list-style-type: none"> 1. If the unit does not rise into position correctly, check the service loops for the signal cables on the bottom of the unit. If the service loop is too small the cables will counteract the spring trying to raise the unit into position.
Unit tilts up too fast	<ol style="list-style-type: none"> 1. If the unit rises into position too fast, check the service loops for the signal cables on the bottom of the unit. If the service loop is too large and the cables are putting upward pressure on the unit, the unit will tilt up too fast.
Unit does not close all the way	<ol style="list-style-type: none"> 1. If the unit does not close flush with the bezel, check the service loops for the signal and power cords on the bottom of the unit. If the service loop is putting upward pressure in the unit, the unit will not be able to seat all the way down.