

DOUBLE WIDE SIZE BACK BOX

104BBX



MATES WITH
VERTICAL SLANT
STYLE POCKET



As part of the Double Wide Stage Pocket System



PROUDLY MADE
IN THE U.S.A.



ACE BACKSTAGE CO
Stage Pocket Systems **Connectivity**
www.acebackstage.com

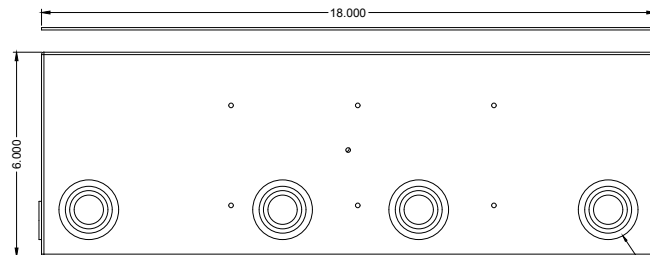
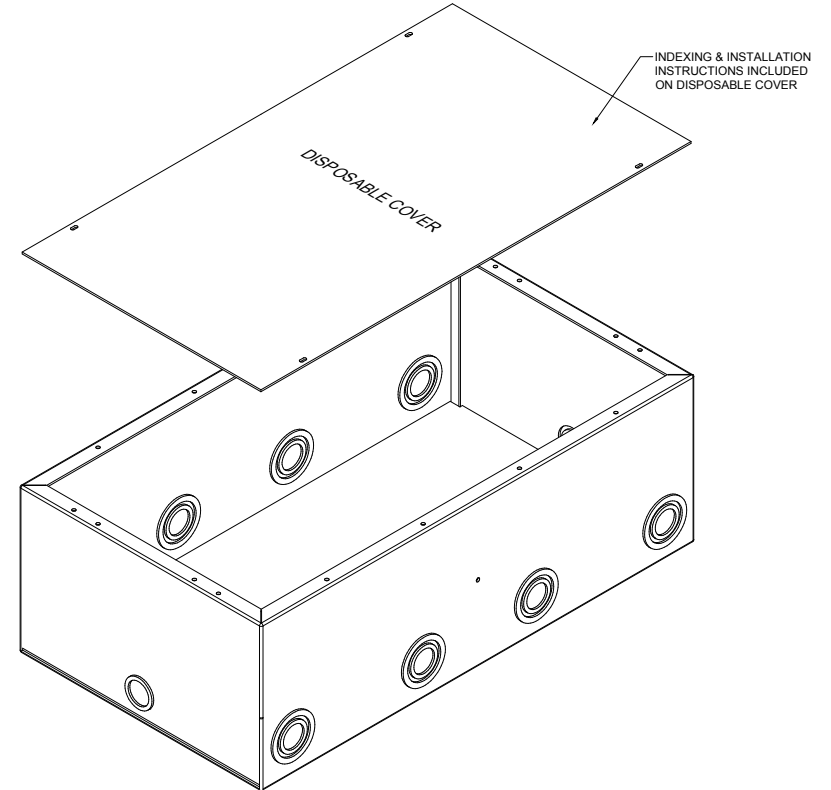
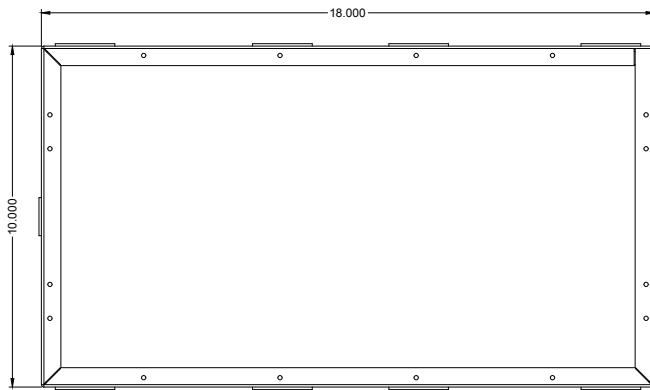

1/2", 3/4", 1", AND 1-1/4" COMBINATION
KNOCKOUTS (4) PLACES TYPICAL ON
OPPOSING SIDES

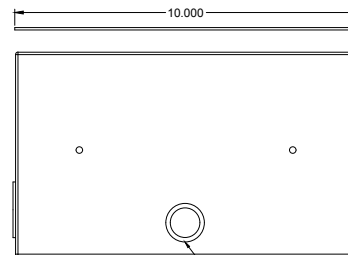

1/2" AND 3/4" COMBINATION
KNOCKOUTS (1) PLACE TYPICAL ON
OPPOSING SIDES

REVISION: 11/2019	FINISH :	COMPATIBLE POCKETS:	DESCRIPTION:	REV 1
ALL DIMENSIONS ARE FOR REFERENCE ONLY. ALL DIMENSIONS ARE IN INCHES	- Electro Deposited Clear Zinc ASTM Certified	Any Double Wide Size Stage Pocket: 124/224/324	Rough in Box for use when installing Double Wide Size Stage Pocket. Made from 14ga CRS.	SHEET 1 OF 1