

NOTE: DARK COLORS HAVE BEEN LIGHTENED FOR CLARITY PURPOSES

RESTRICTION: The information contained in the proposal is confidential and proprietary to Stewart Filmscreen Corporation, shall not be disclosed beyond the vendor company, and shall not be duplicated, used, or disclosed inwhole or in part for any purpose except to evaluate this proposal.

DIMENSIONS ARE Inches [mm]		DRAWN BY:		Stewart FILMSCREEN 1161 W. Sepulveda Blvd., Torrance, CA 90502 Customer Care (800) 762-4999 Fax (310) 326-6870	
TOLERANCES: +/- 1/8 in (UNLESS OTHERWISE SPECIFIED)		Engineering			
APPROXIMATE SCREEN WEIGHT: 60 LBS		DRAWING TYPE:		TITLE CIMA ABOVE CEILING	
APPROXIMATE SHIPPING WEIGHT: 151 LBS		Typical			
MODEL #: CIAC123DW-6-2-5		CREATION DATE: 7/31/14			
CASE COLOR: White		SIZE A	SHEET 1 OF 7	PART NO. 00920	REV.

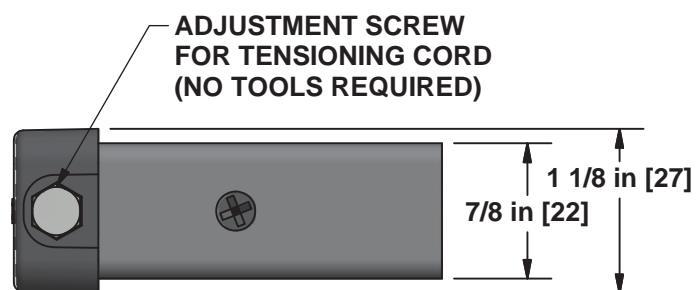

BATTEN END CAP
REFLECTED CEILING VIEW

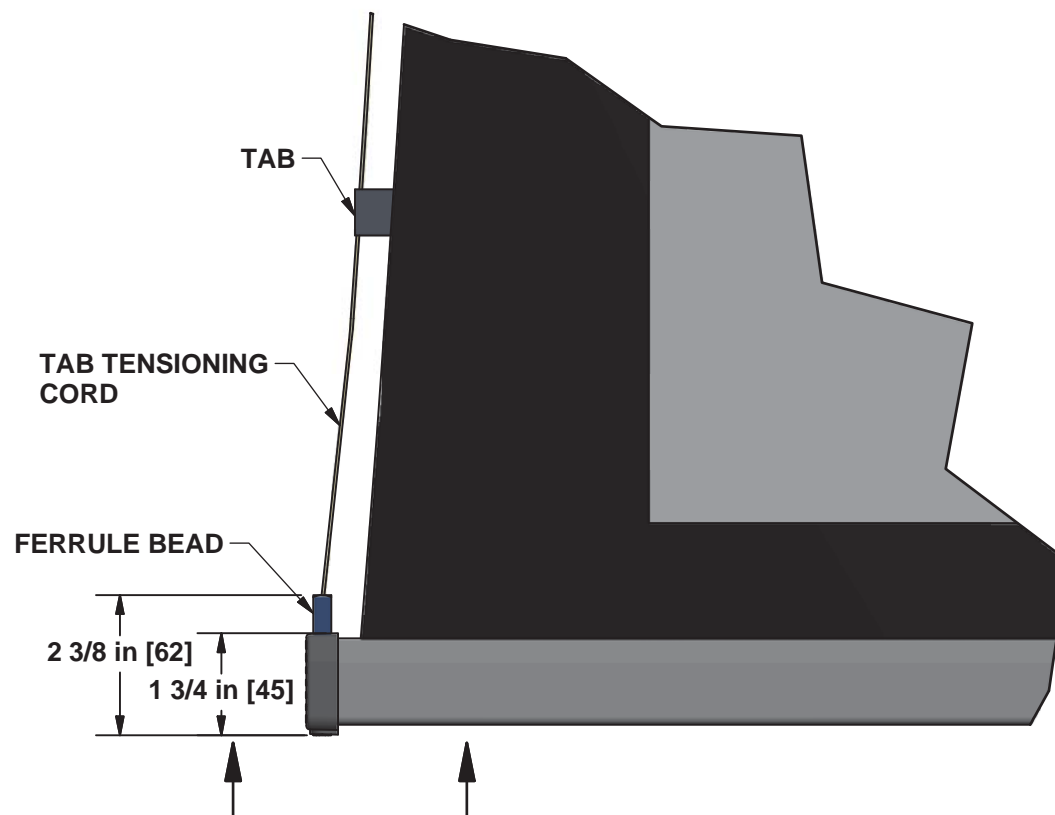

BATTEN DETAIL
TAB TENSIONING VIEW

RESTRICTION: The information contained in the proposal is confidential and proprietary to Stewart Filmscreen Corporation, shall not be disclosed beyond the vendor company, and shall not be duplicated, used, or disclosed in whole or in part for any purpose except to evaluate this proposal.

Z:\Inventor Reference Folder\00910 CIMA AC Typical\00910 CIMA AC Typical.idw

DIMENSIONS ARE Inches [mm]		DRAWN BY: Engineering		<div>Stewart FILMSCREEN</div> <div>1161 W. Sepulveda Blvd., Torrance, CA 90502</div> <div>Customer Care (800) 762-4999 Fax (310) 326-6870</div>	
TOLERANCES: +/- 1/8 in (UNLESS OTHERWISE SPECIFIED)		DRAWING TYPE: Typical			
APPROXIMATE SCREEN WEIGHT: 60 LBS		CREATION DATE: 7/31/14			
APPROXIMATE SHIPPING WEIGHT: 151 LBS		TITLE CIMA ABOVE CEILING			
MODEL #: CIAC123DW-6-2-5					
CASE COLOR: White		SIZE A	SHEET 2 OF 7	PART NO. 00920	REV.

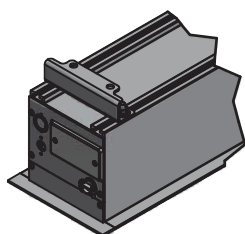
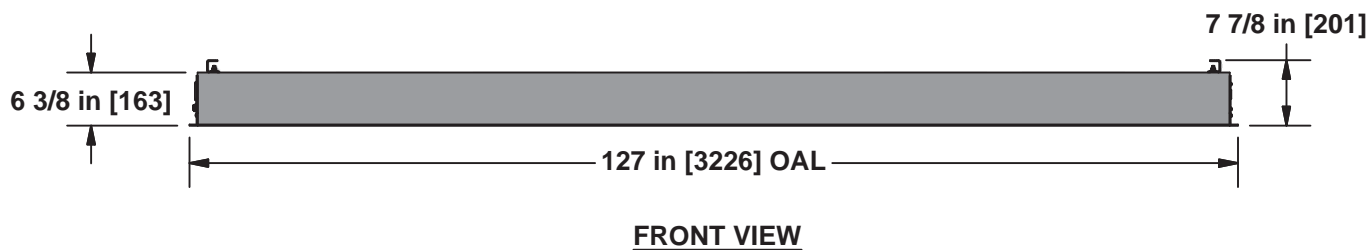
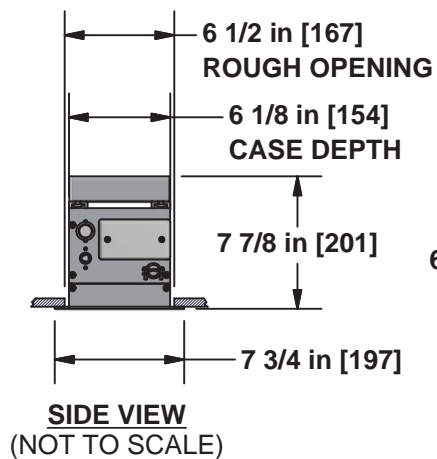
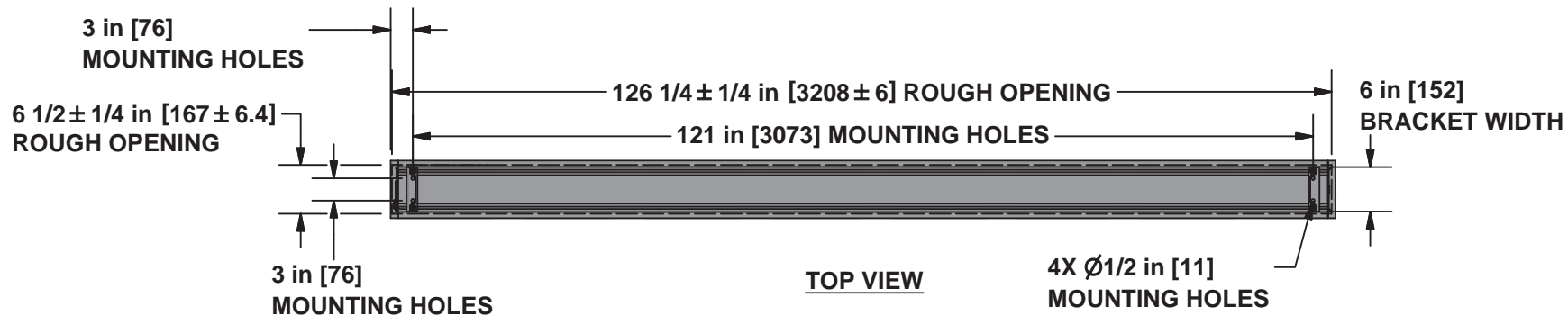
**ISOMETRIC VIEW**

MOUNTING BRACKET STANDARD

DIMENSIONS ARE Inches [mm]		DRAWN BY: Engineering		Stewart FILM SCREEN 1161 W. Sepulveda Blvd., Torrance, CA 90502 Customer Care (800) 762-4999 Fax (310) 326-6870	
TOLERANCES: +/- 1/8 in (UNLESS OTHERWISE SPECIFIED)		DRAWING TYPE: Typical			
APPROXIMATE SCREEN WEIGHT: 60 LBS		CREATION DATE: 7/31/14		TITLE CIMA ABOVE CEILING	
APPROXIMATE SHIPPING WEIGHT: 151 LBS					
MODEL #: CIAC123DW-6-2-5					
CASE COLOR: White		SIZE A	SHEET 3 OF 7	PART NO. 00920	REV.

RESTRICTION: The information contained in the proposal is confidential and proprietary to Stewart Filmscreen Corporation, shall not be disclosed beyond the vendor company, and shall not be duplicated, used, or disclosed in whole or in part for any purpose except to evaluate this proposal.

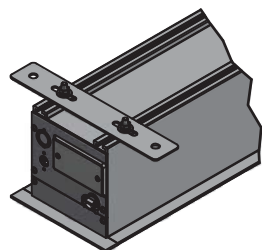
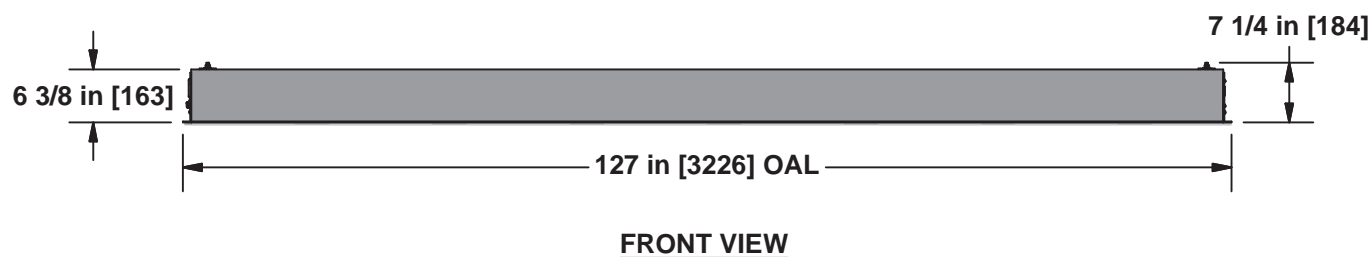
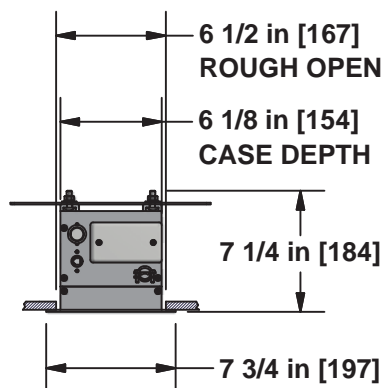
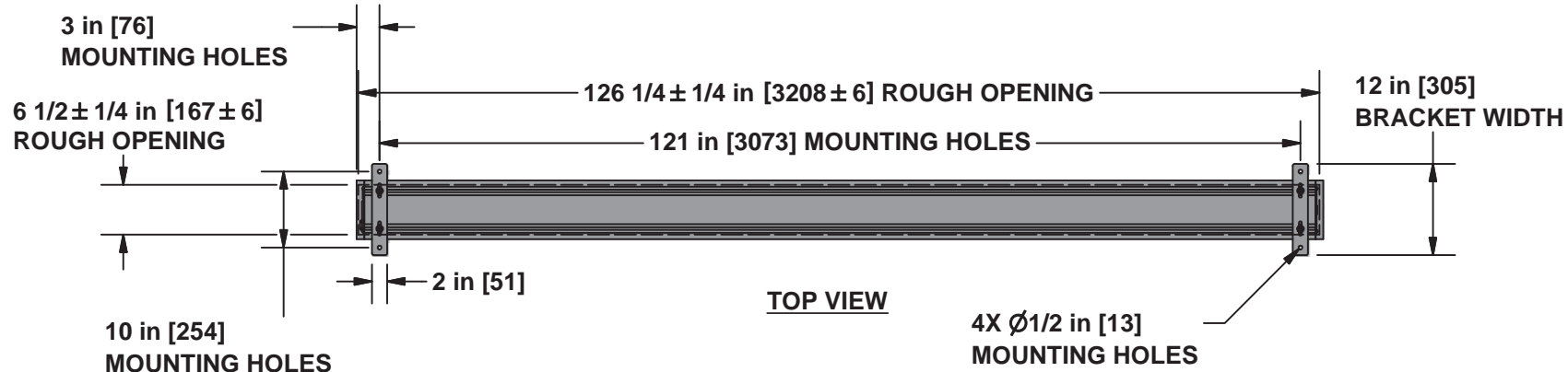
**ISOMETRIC VIEW**

MOUNTING BRACKET **OPTIONAL**

DIMENSIONS ARE Inches [mm]		DRAWN BY: Engineering		<div>Stewart FILMSCREEN</div> <div>1161 W. Sepulveda Blvd., Torrance, CA 90502</div> <div>Customer Care (800) 762-4999 Fax (310) 326-6870</div>	
TOLERANCES: +/- 1/8 in (UNLESS OTHERWISE SPECIFIED)		DRAWING TYPE: Typical			
APPROXIMATE SCREEN WEIGHT: 60 LBS		CREATION DATE: 7/31/14			
APPROXIMATE SHIPPING WEIGHT: 151 LBS		TITLE			
MODEL #: CIAC123DW-6-2-5				CIMA ABOVE CEILING	
CASE COLOR: White				SIZE A	SHEET 4 OF 7
				PART NO. 00920	REV.

RESTRICTION: The information contained in the proposal is confidential and proprietary to Stewart Filmscreen Corporation, shall not be disclosed beyond the vendor company, and shall not be duplicated, used, or disclosed in whole or in part for any purpose except to evaluate this proposal.

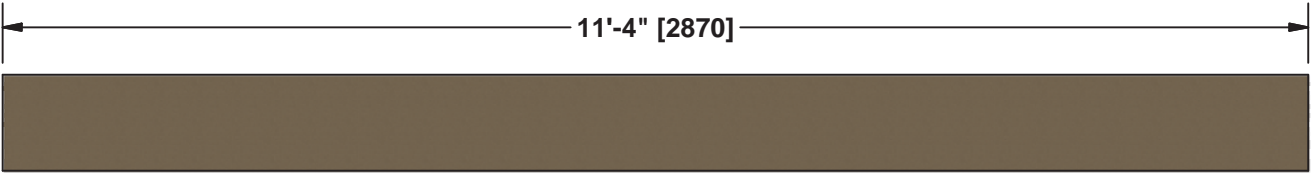

TOP VIEW

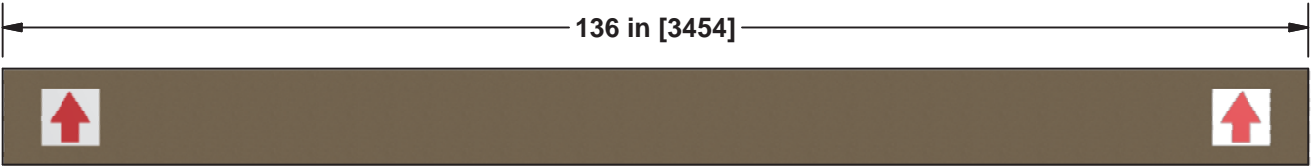

FRONT VIEW

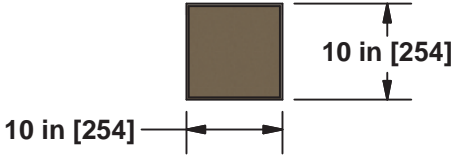

SIDE VIEW

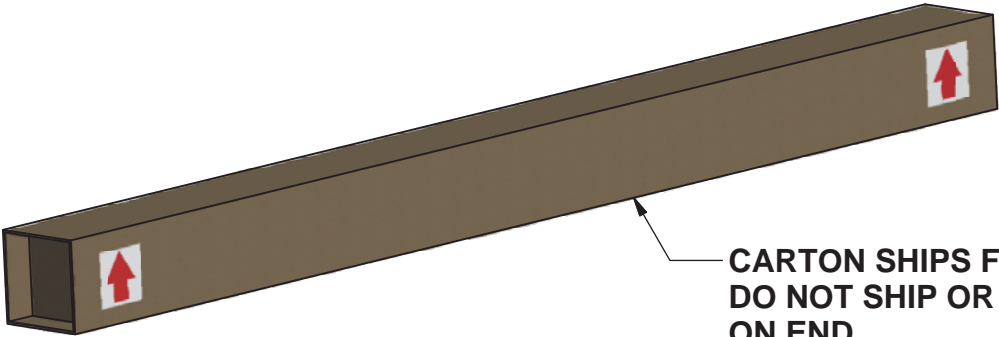

**CARTON SHIPS FLAT
DO NOT SHIP OR STORE
ON END**

RESTRICTION: The information contained in the proposal is confidential and proprietary to Stewart Filmscreen Corporation, shall not be disclosed beyond the vendor company, and shall not be duplicated, used, or disclosed inwhole or in part for any purpose except to evaluate this proposal.

DIMENSIONS ARE Inches [mm]		DRAWN BY:		Stewart FILMSCREEN 1161 W. Sepulveda Blvd., Torrance, CA 90502 Customer Care (800) 762-4999 Fax (310) 326-6870			
TOLERANCES: +/- 1/8 in (UNLESS OTHERWISE SPECIFIED)		Engineering					
APPROXIMATE SCREEN WEIGHT: 60 LBS		DRAWING TYPE: Typical					
APPROXIMATE SHIPPING WEIGHT: 151 LBS		CREATION DATE: 7/31/14					
MODEL #: CIAC123DW-6-2-5				TITLE CIMA ABOVE CEILING			
CASE COLOR: White				SIZE A	SHEET 5 OF 7	PART NO. 00920	REV.

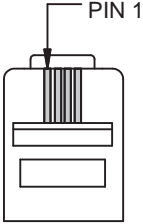

4 PIN:

PIN	SIGNAL
1	COMMON
2	LV1
3	LV2
4	STI

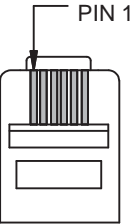

6 PIN:

PIN	SIGNAL
1	NOT USED
2	COMMON
3	LV1
4	LV2
5	STI
6	NOT USED

STI INPUT
4 PIN OR 6 PIN
RJ25 CONNECTOR
SEE CHART

POWER CONDUIT

WHITE (COMMON)

BLACK (HOT)

GREEN (GROUND)

120 VOLT WIRING

RESTRICTION: The information contained in the proposal is confidential and proprietary to Stewart Filmscreen Corporation, shall not be disclosed beyond the vendor company, and shall not be duplicated, used, or disclosed inwhole or in part for any purpose except to evaluate this proposal.

DIMENSIONS ARE inches [mm]		DRAWN BY:		Stewart FILMSCREEN 1161 W. Sepulveda Blvd., Torrance, CA 90502 Customer Care (800) 762-4999 Fax (310) 326-6870			
TOLERANCES: +/- 1/8 in (UNLESS OTHERWISE SPECIFIED)		Engineering					
APPROXIMATE SCREEN WEIGHT: 60 LBS		DRAWING TYPE: Typical					
APPROXIMATE SHIPPING WEIGHT: 151 LBS		CREATION DATE: 7/31/14					
MODEL #: CIAC123DW-6-2-5				TITLE CIMA ABOVE CEILING			
CASE COLOR: White				SIZE A	SHEET 6 OF 7	PART NO. 00920	REV.

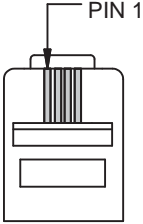

4 PIN:

PIN	SIGNAL
1	COMMON
2	LV1
3	LV2
4	STI

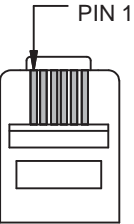

6 PIN:

PIN	SIGNAL
1	NOT USED
2	COMMON
3	LV1
4	LV2
5	STI
6	NOT USED

STI INPUT
4 PIN OR 6 PIN
RJ25 CONNECTOR
SEE CHART

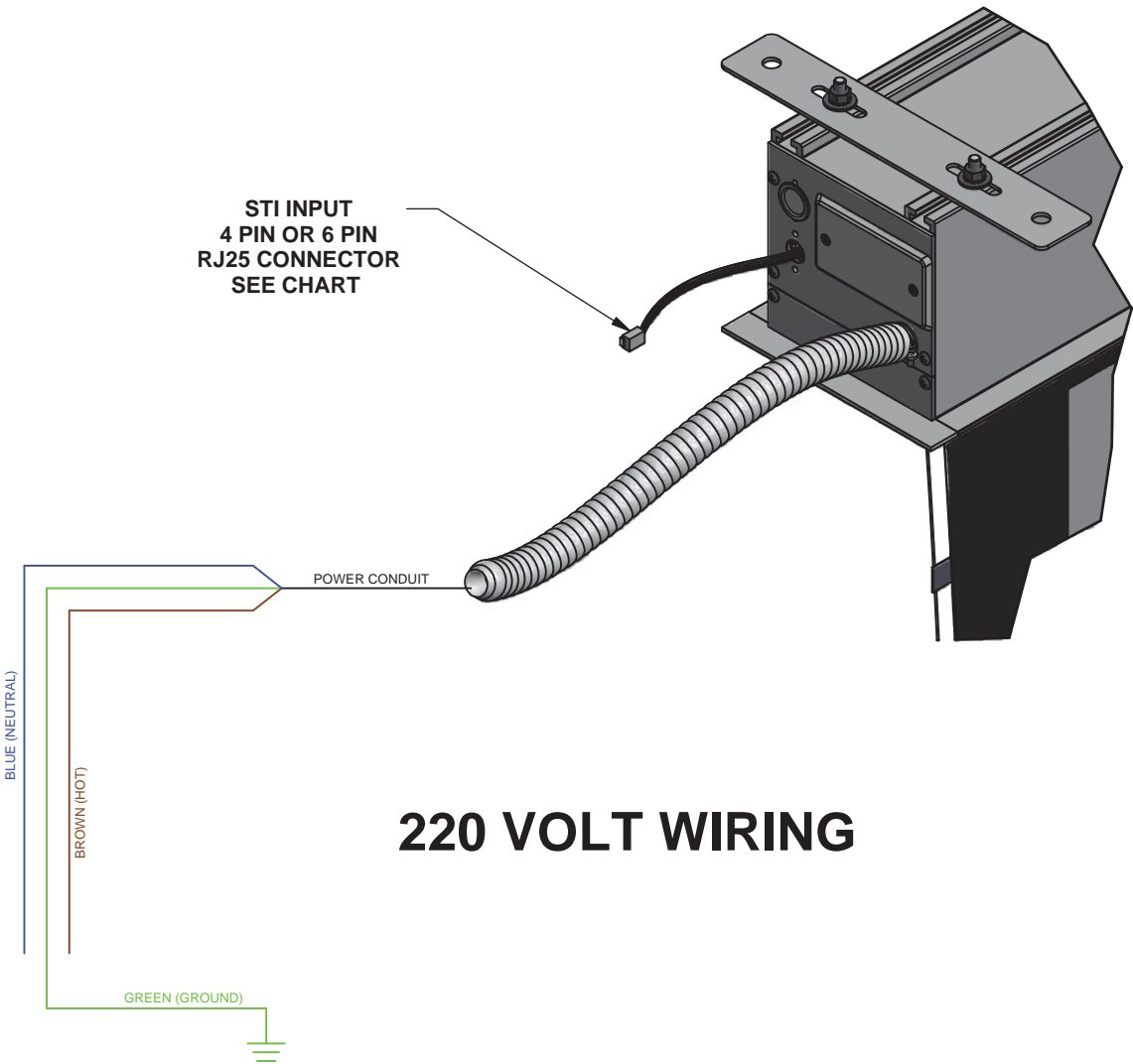

220 VOLT WIRING

RESTRICTION: The information contained in the proposal is confidential and proprietary to Stewart Filmscreen Corporation, shall not be disclosed beyond the vendor company, and shall not be duplicated, used, or disclosed inwhole or in part for any purpose except to evaluate this proposal.

DIMENSIONS ARE Inches [mm]	DRAWN BY:	Stewart FILMSCREEN 1161 W. Sepulveda Blvd., Torrance, CA 90502 Customer Care (800) 762-4999 Fax (310) 326-6870		
TOLERANCES: +/- 1/8 in (UNLESS OTHERWISE SPECIFIED)	Engineering			
APPROXIMATE SCREEN WEIGHT:	DRAWING TYPE:	TITLE CIMA ABOVE CEILING		
60 LBS	Typical			
APPROXIMATE SHIPPING WEIGHT:	CREATION DATE:	SIZE	SHEET	PART NO.
151 LBS	7/31/14	A	7 OF 7	00920
MODEL #:	REV.			
CIAC123DW-6-2-5				
CASE COLOR:				
White				